



SPARE PARTS LIST

ZUNDAPP-MOTORCYCLE

KS 601 Elastic

Published in August 1957



SPARE PARTS LIST

ZÜNDAPP-MOTORCYCLE

KS 601 Elastic

Published in August 1957

— Printed in Germany —

Contents

	Page	Illustration
Introduction	5	
Group M:		
a) Engine (assembly)	7	1
b) Housing and cylinders		
Crankcase	9	2
Crankcase cover, housing cap	13	3
Oil sump, oil filter	15	4
Cylinder and cylinder head	17	5
c) Drive mechanism		
Crankshaft, connecting rods, pistons	21	6
d) Valve drive		
Camshaft and valves	25	7
e) Oil pump	29	8
f) Carburetors	31	9
Air cleaner and suction manifold	35	10
g) Clutch, clutch operating mechanism	37	11
Group G:		
a) Change-speed gear unit (assembly)		
b) Gear set case	39	12
c) Shafts and chain drive gears	43	13
d) Footshift mechanism	47	14
e) Kickstarter	51	15
Group H:		
a) Rear end drive gear unit (assembly)		
b) Rear end drive housing with cover	55	16
c) Shaft drive unit	59	17
Group R:		
a) Frame	61	18
Swinging arm	63	19
Spring unit	65	19a
b) Foot rests and dual seat	67	20
c) Fenders		
Front wheel fender, front wheel stand	69	21
Rear wheel fender, safety bars	71	22
d) Fuel tank and fuel pipes	75	23
e) Exhaust set	79	24
f) Front fork (assembly)		
Front fork suspension, fork legs	81	25
Shock absorber and steering damper	85	26
g) Handlebar and hand levers with cables	87	27

	Page	Illustration
Group B: a) Brakes		
Handbrake	91	28
Footbrake	93	29
b) Wheels	97	30
Group E: a) Electrical equipment		
Generator	99	31
Headlight, battery, horn, ignition coil, taillight	101	32
Group W: a) Tool box with tools	107	33

INTRODUCTION

Please take note that only **Genuine Zündapp Spares** will be the safeguard for security, claims under guarantee, and will prevent many a damage and loss.

Therefore, do not use parts of another origin but demand only **Genuine Zündapp Spares** from your Zündapp dealer, for by fitting imitated parts any claim under guarantee will automatically become void.

In order to avoid errors, queries, and incorrect deliveries, please quote with all orders for spare parts:

1. **Description and number of the spare part wanted**
in accordance with this list,
2. **Frame number**
stamped into the rating plate,
3. **Modifications made on the vehicle**
by exchanging spare parts or groups.

If these data cannot be given it will be necessary to send in a pattern labelled with the sender's name and address. These patterns will be returned to the sender only upon request.

Model Order

Re. Frame No. 555 123

1 crankshaft	No. 1951 z 14
1 cylinder, left-hand	No. 2162 z 24
1 piston	No. 883 z 151
2 piston rings	No. 1262 z 11

Deliveries of spare parts are only made through our respective representatives.

All illustrations and data in this list are not binding. We reserve the right for alterations without previous notice.

ZÜNDAPP-WERKE G.M.B.H., NÜRNBERG-MÜNCHEN
NÜRNBERG WORKS

Illustration 1, Group M: a) Engine (Assembly)

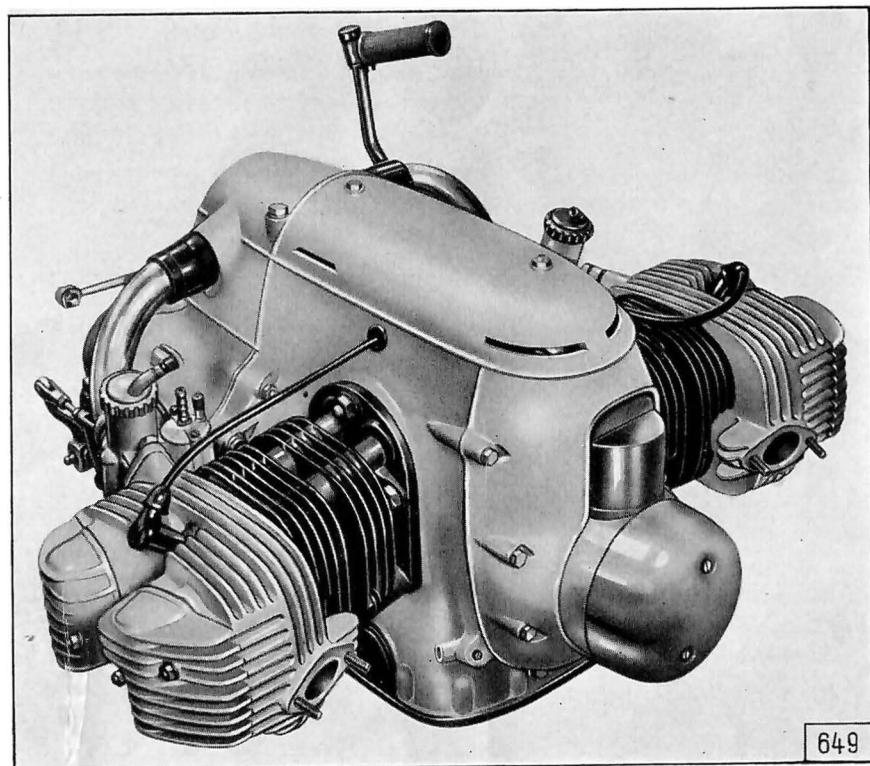

Illustration 1, Group M: a) Engine (Assembly)

Key No.	Spare Part No.	Description	No. of Pieces	Remarks
—	6590 k 260	Engine complete with gearbox . .	1	
—	6580 k 209	Engine complete, but without gearbox, carburettor, suction manifold, air cleaner, and housing cap	1	

Illustration 2, Group M: b) Housing and Cylinders, Crankcase

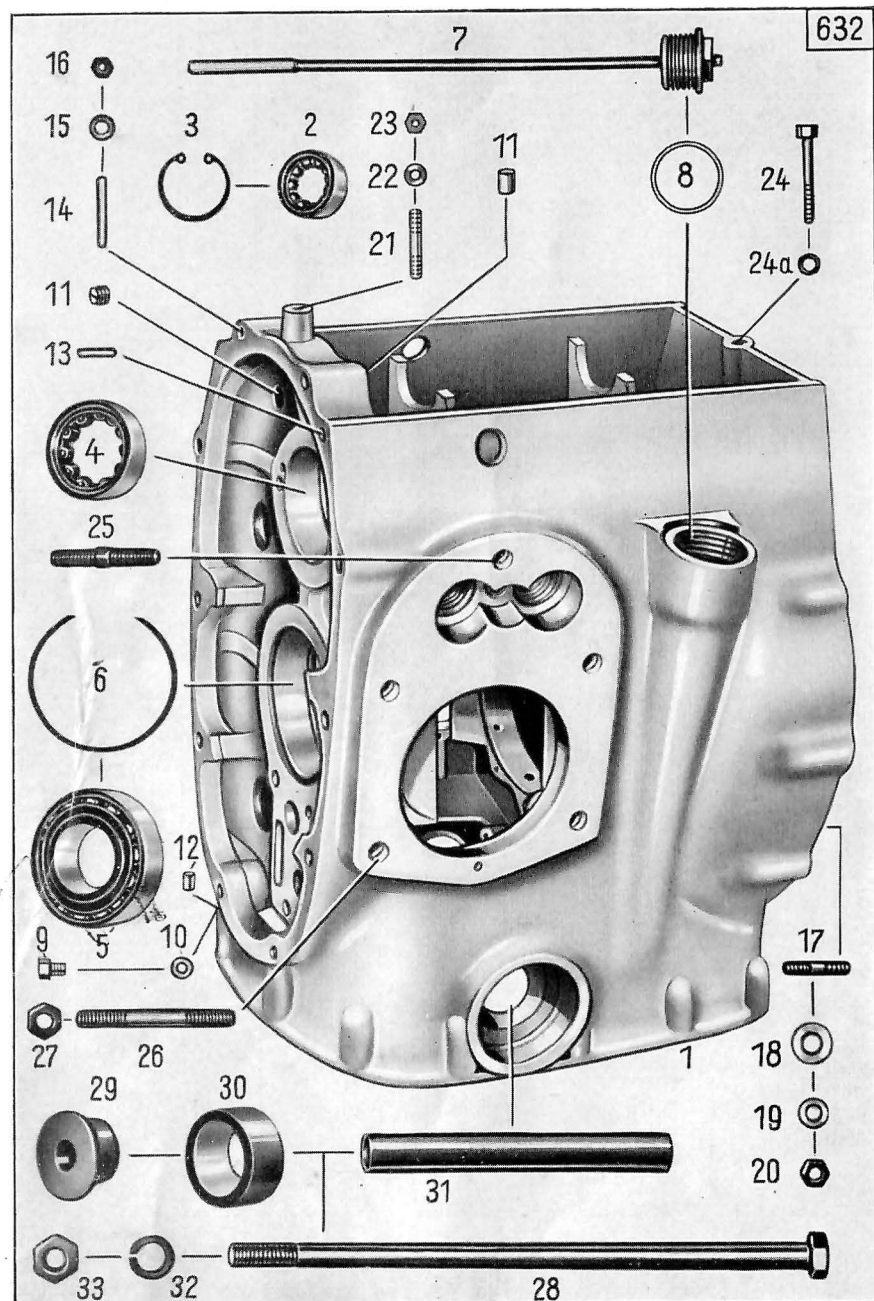

Illustration 2, Group M: b) Housing and Cylinders, Crankcase

Key No.	Spare Part No.	Description	No. of Pieces	Remarks
Crankcase				
1	510 k 82	crankcase complete	1	
2	—	roller bearing without inner ring RWUL 15 DIN 5412 (to rear part of camshaft) . . .	1	
3	—	circlip 35 x 1,5 DIN 472 (to rear roller bearing inside camshaft)	1	
4	—	roller bearing without inner ring RNUL 25 DIN 5412 (to fore part of camshaft) . . .	1	
—	—	circlip 52 x 2 DIN 472	1	
5	6840 z 44	roller bearing complete (fore crankshaft bearing) . . .	1	
6	1251 z 55	internal spring washer (to fasten fore crankshaft bearing in crankcase)	2	
7	1550 z 18	oil dip stick (for measuring oil in engine)	1	
8	—	packing washer C 30 x 36 DIN 7603 (to oil dip stick)	1	
9	—	hex. screw M 10 x 15 DIN 933 k (to bore for checking oil pressure) .	1	
10	—	packing washer A 10 x 16 DIN 7603 (to hex. screw)	1	
11	1803 z 2	lock plug (to lock oil circulation bores)	2	
12	1803 z 52	lock plug	1	
13	—	cylindrical pin 5 m 6 x 18 DIN 7 (to fasten crankcase cover to crank- case)	1	
14	—	stud M 6 x 22 DIN 940 (to fasten crankcase cover to crankcase) .	2	
15	—	washer 7 DIN 126	2	
16	—	hex. nut M 6 DIN 934 k	2	

Illustration 2, Group M: b) Housing and Cylinders, Crankcase

Key No.	Spare Part No.	Description	No. of Pieces	Remarks
17	—	stud M 8 x 15 DIN 835 (to fasten bearing plate to crankcase) . . .	11	
18	1301 z 056	safety washer	11	
19	—	spring washer A 8 DIN 137	11	
20	—	hex. nut M 8 DIN 934	11	
21	—	stud M 6 x 32 DIN 835 k (to fasten housing cap to crankcase) . . .	1	
22	—	spring washer B 6 DIN 137 k . . .	1	
23	—	hex. nut M 6 DIN 934 k	1	
24	—	hex. screw M 6 x 65 DIN 931 k (to housing cap)	1	
24a	—	spring washer B 6 DIN 137 k . . .	1	
25	—	stud M 10 x 25 DIN 835 k (to fasten cylinders to crankcase)	6	
26	—	stud AM 10 x 55 DIN 835 k (to fasten cylinders to crankcase) .	4	
27	—	hex. nut M 10 DIN 934 k	10	
28	—	hex. screw M 14 x 1,5 x 300 DIN 960 a (to fasten crankcase to frame)	1	
29	1241 z 19	supporting ring	2	
30	1236 z 25	rubber bushing	2	
31	1331 z 28	spacer tube	1	
32	—	spring washer A 14 DIN 127 k . . .	1	
33	—	hex. nut M 14 x 1,5 DIN 934 a . . .	1	
—	1806 z 37	rubber grommet (to positive cable of ignition coil)	1	

Illustration 3, Group M: b) Housing and Cylinders, Crankcase Cover, Housing Cap

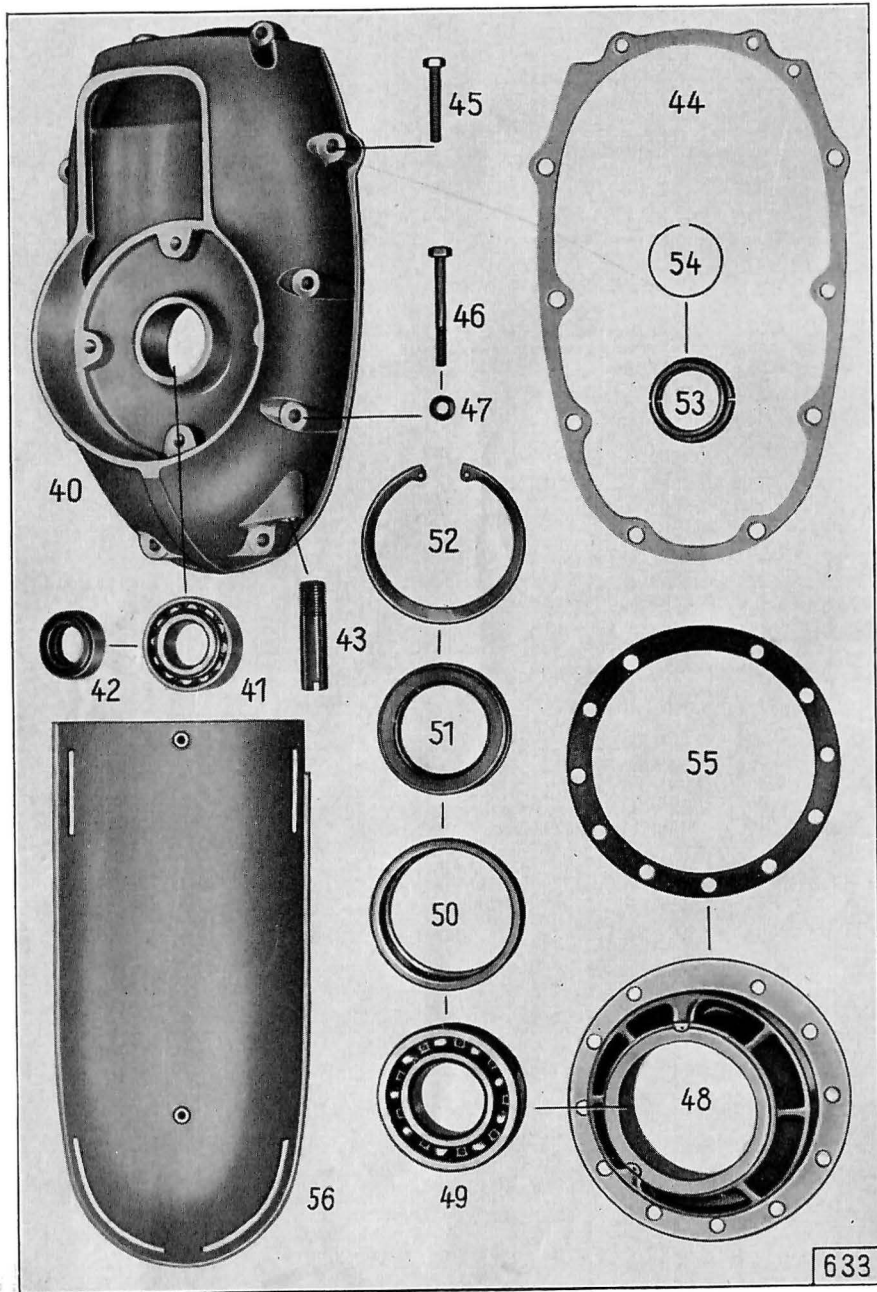

Illustration 3, Group M: b) Housing and Cylinders, Crankcase Cover, Housing Cap

Key No.	Spare Part No.	Description	No. of Pieces	Remarks
Crankcase Cover				
40	263 z 19	crankcase cover	1	
41	—	roller bearing NL 25 DIN 5412 (to crankshaft)	1	
42	6860 z 80	packing ring (to crankshaft)	1	
43	1331 z 148	gas escape pipe (to crankcase cover)	1	
44	468 z 68	gasket (between crankcase cover and crankcase)	1	
45	—	hex. screw M 7 x 40 DIN 933 k (to fasten crankcase cover)	4	
46	—	hex. screw M 7 x 60 DIN 931 k (to fasten crankcase cover)	4	
47	—	washer 7 DIN 126 k	8	
48	231 z 202	bearing plate (to rear crankshaft bearing)	1	
49	—	ball bearing 6208 M DIN 625 (to crankshaft)	1	
—	1301 z 216	spacer washer	1	{ as required
50	1231 z 63	bearing ring (to oil seal)	1	
51	6860 z 86	oil seal (to crankshaft)	1	
52	—	criclip 80 x 2,5 DIN 472 (to ball bearing)	1	
53	1251 z 33	safety washer (consisting of two parts)	2	{ as required
—	1251 z 34	safety washer (two parts)	2	
—	1251 z 35	safety washer (two parts)	2	
54	1251 z 13	snap ring (to safety washer)	1	
55	468 z 306	gasket (between bearing plate and crankcase)	1	
Housing Cap				
56	653 z 103	housing cap (for fixing see crankcase)	1	

Illustration 4, Group M: b) Housing and Cylinders, Oil Sump, Oil Filter

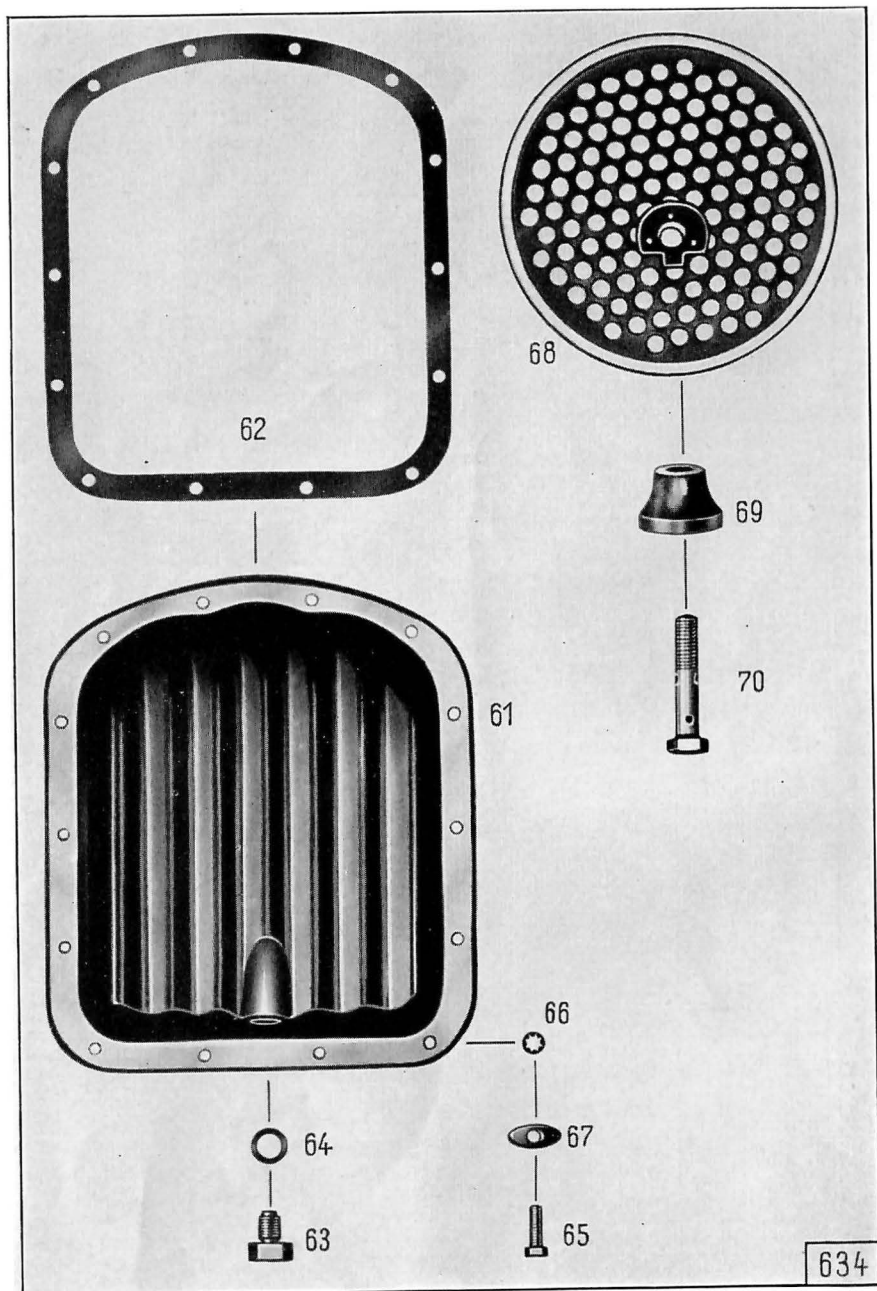

Illustration 4, Group M: b) Housing and Cylinders, Oil Sump, Oil Filter

Key No.	Spare Part No.	Description	No. of Pieces	Remarks
Oil Sump				
61	1901 z 7	oil sump	1	
62	468 z 55	gasket (to oil sump)	1	
63	—	hex. screw M 12 x 1,5 x 10 DIN 960 k (for oil draining)	1	
64	—	packing washer A 12 x 18 DIN 7603 (to oil draining screw)	1	
65	—	hex. screw M 6 x 20 DIN 931 k (to fasten oil sump to crankcase) . .	14	
66	—	shake proof (toothed) washer J 6,4 DIN 6797 k	14	
67	1301 z 179	washer	14	
Oil Filter				
68	6410 z 82	oil filter	1	
69	177 z 2	spacer	1	
70	1551 z 147	hollow screw (to fasten oil filter to crankcase)	1	

Illustration 5, Group M: b) Housing and Cylinders, **Cylinder and Cylinder Head**

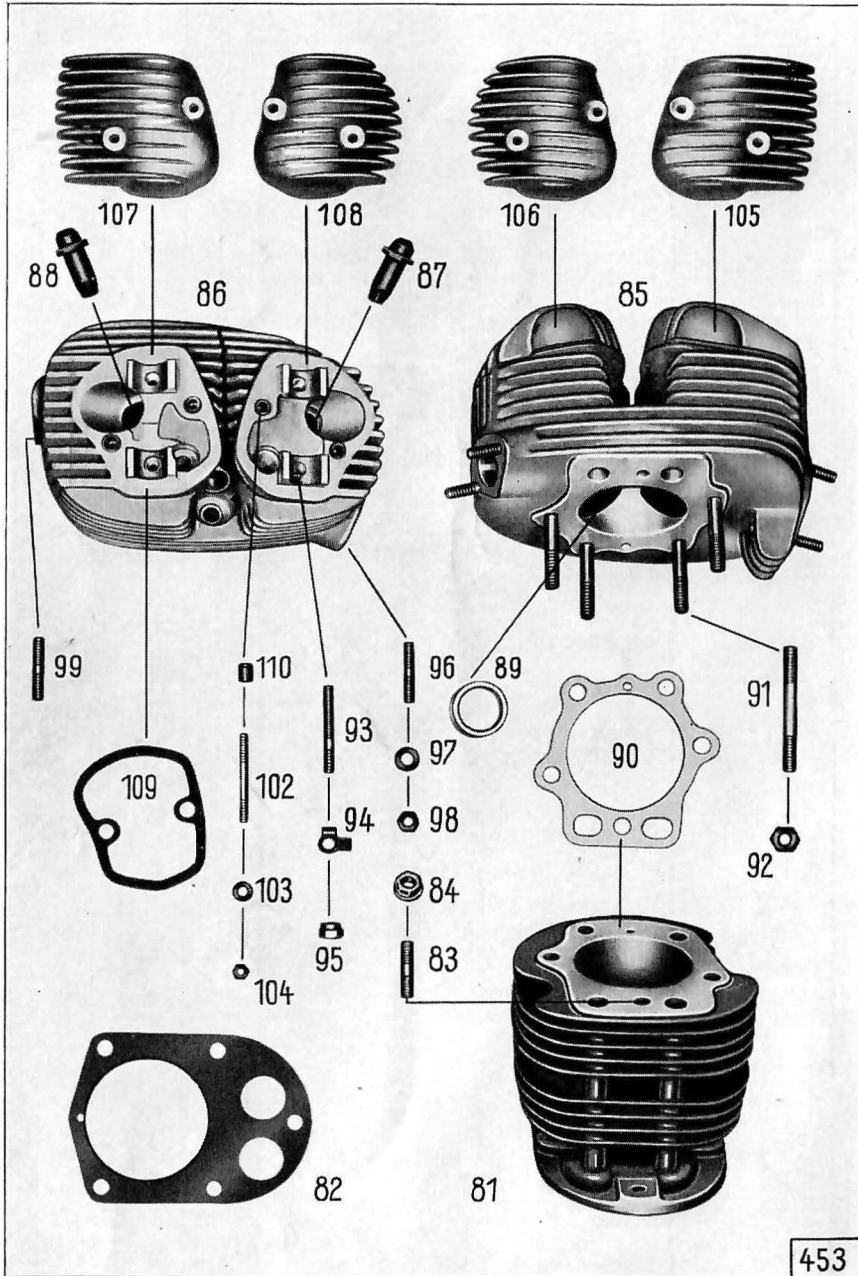

Illustration 5, Group M: b) Housing and Cylinders, **Cylinder and Cylinder Head**

Key No.	Spare Part No.	Description	No. of Pieces	Remarks
Cylinder				
81	2162 z 24	cylinder, left-hand	1	
—	2162 z 25	cylinder, right-hand	1	
82	468 z 64	cylinder base gasket	2	
83	—	stud M 10 x 28 DIN 939 k (to fasten cylinder to cylinder head)	2	
84	1001 z 31	nut	2	
Cylinder Head				
85	270 k 66	cylinder head, left-hand, complete (with valves, rocker arms, and rocker caps)	1	
—	270 k 67	cylinder head, right-hand, complete (with valves, rocker arms, and rocker caps)	1	
—	270 k 64	cylinder head, left-hand, with valve guides	1	
86	270 k 65	cylinder head, right-hand, with valve guides	1	
87	194 z 5	valve guide bushing, outer diameter 15.5 mm (intake and exhaust)	4	
88	—	not mounted with model KS 601 El.	—	
89	1232 z 1	valve seat ring	4	} mounting can only be done at our works
90	469 z 19	cylinder head gasket	2	
91	—	stud M 10 x 60 DIN 940 k (to fasten cylinder head to cylinder)	8	
92	—	hex. nut M 10 DIN 934 k	8	
93	1561 z 36	stud (to fasten rocker arms to cylinder head)	8	
94	1291 z 13	safety washer	8	
95	1001 z 47	hex. nut	8	

Illustration 5, Group M: b) Housing and Cylinders, Cylinder and Cylinder Head

Key No.	Spare Part No.	Description	No. of Pieces	Remarks
96	—	stud M 8 x 22 DIN 940 k (to fasten carburettors to cylinder head) .	4	
97	—	washer 8,4 DIN 433	4	
98	—	hex. nut M 8 DIN 934 k	4	
99	—	stud M 8 x 22 DIN 940 (to fasten exhaust pipes to cylinder head)	4	
102	—	stud M 6 x 45 DIN 940 k (to fasten rocker caps to cylinder head) .	8	
103	—	washer 6,4 DIN 125 k	8	
104	—	hex. nut M 6 DIN 934 k	8	
105	653 z 7	left front rocker cap	1	
106	653 z 20	left rear rocker cap	1	
107	653 z 8	right front rocker cap	1	
108	653 z 21	right rear rocker cap	1	
109	468 z 13	rocker cap gasket	4	
110	1331 z 33	spacer	8	

Illustration 6, Group M: c) Drive Mechanism, Crankshaft, Connecting Rods, and Pistons

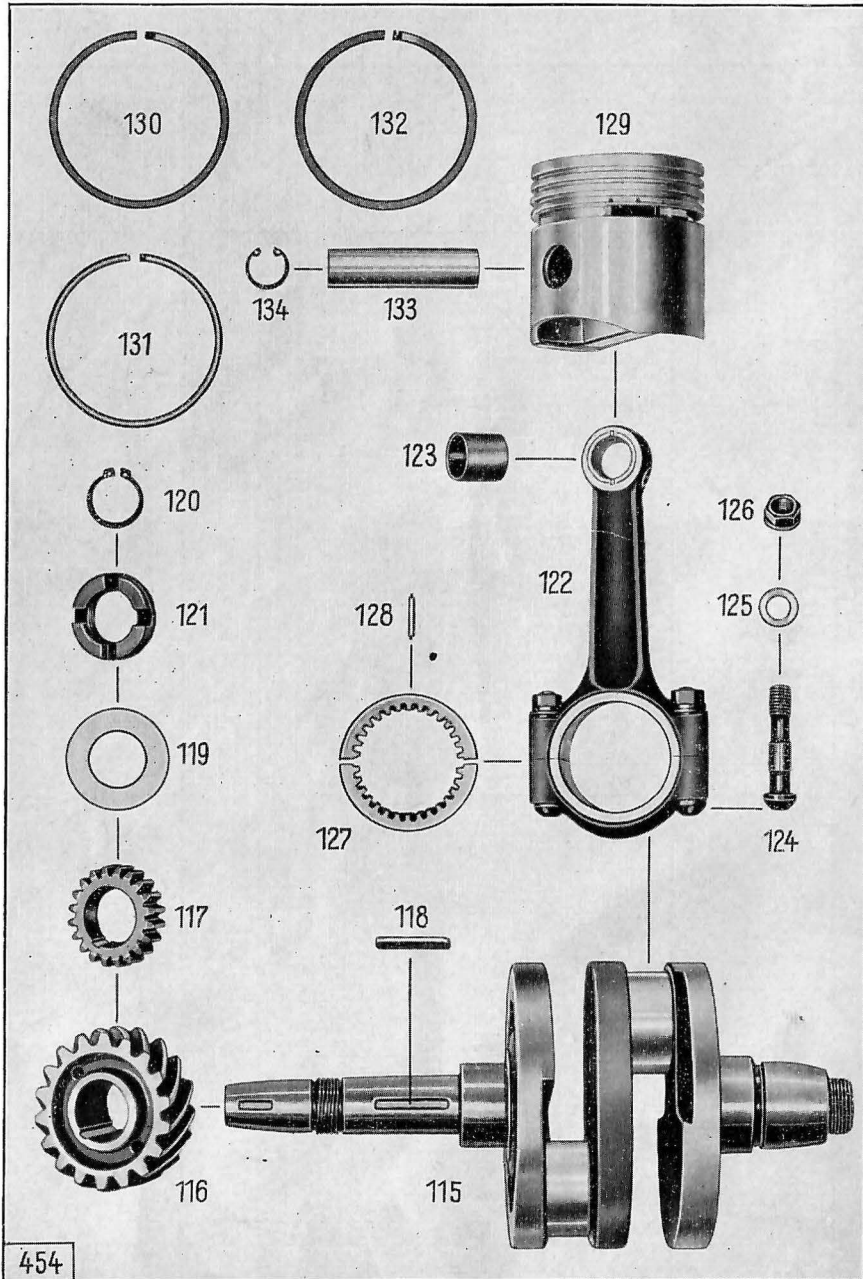

454

Illustration 6, Group M: c) Drive Mechanism, Crankshaft, Connecting Rods, and Pistons

Key No.	Spare Part No.	Description	No. of Pieces	Remarks
Crankshaft				
115	1951 z 14	crankshaft	1	
116	2131 z 50	gear (for cam drive)	1	
117	2131 z 32	gear (for oil pump drive)	1	
118	—	key A 4 x 4 x 32 DIN 6885 (to fasten gears to crankshaft)	1	
119	—	not mounted with model KS 601 El.	—	
120	—	not mounted with model KS 601 El.	—	
121	1011 z 4	round nut (to fasten gears to crankshaft)	1	
Connecting Rods				
122	1160 k 50	connecting rod	2	
123	184 z 289	gudgeon pin bushing	2	
124	1571 z 12	connecting rod screw	4	
125	1301 z 344	washer	4	
126	1001 z 113	hex. nut	4	
127	1874 z 5	cage ring	2	
128	1871 z 101	bearing needle	60	
Pistons				
129	883 z 151	piston 75.0 mm \varnothing (standard)	2	
—	2473 k 83	piston 75.50 mm \varnothing (1st oversize)	2	
—	2473 k 84	piston 76.0 mm \varnothing (2nd oversize)	2	
130	1262 z 20	piston ring 75.0 mm \varnothing (standard)	4	
—	2442 k 22	piston ring 75.50 mm \varnothing (1st oversize)	4	
—	2442 k 23	piston ring 76.0 mm \varnothing (2nd oversize)	4	
131	1262 z 21	piston ring 75.0 mm \varnothing (standard)	2	

Illustration 6, Group M: c) Drive Mechanism, Crankshaft, Connecting Rods, and Pistons

Key No.	Spare Part No.	Description	No. of Pieces	Remarks
—	2442 k 27	piston ring 75.50 mm \varnothing (1st oversize)	2	
—	2442 k 28	piston ring 76.0 mm \varnothing (2nd oversize)	2	
132	1262 z 22	oil scraper ring 75.0 mm \varnothing (standard)	2	
—	2442 k 32	oil scraper ring 75.50 mm \varnothing (1st oversize)	2	
—	2442 k 33	oil scraper ring 76.0 mm \varnothing (2nd oversize)	2	
133	121 z 63	gudgeon pin	2	
134	—	circlip 18 x 1 DIN 472	4	

Illustration 7, Group M: d) Valve Drive, Camshaft and Valves

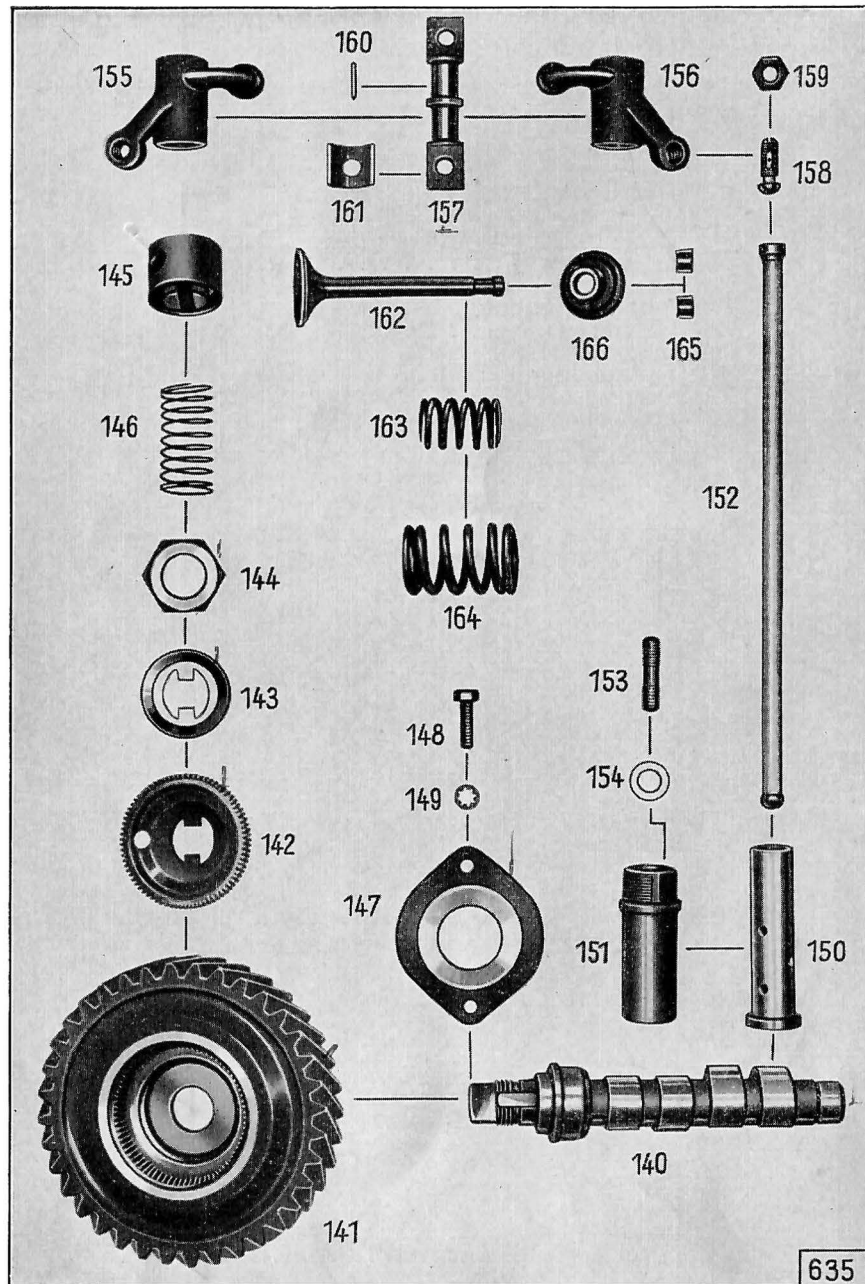

Illustration 7, Group M: d) Valve Drive, Camshaft and Valves

Key No.	Spare Part No.	Description	No. of Pieces	Remarks
Camshaft with Drive				
140	1961 z 25	camshaft	1	
141	2139 z 16	gear (to camshaft)	1	
142	961 z 43	connecting piece (to gear)	1	
143	1291 z 24	safety washer	1	
144	1001 z 207	hex. nut (to fasten gear with connecting piece to camshaft)	1	
145	481 z 214	breather	1	
146	321 z 92	breather spring	1	
147	204 z 1	guide plate (to camshaft)	1	
148	—	hex. screw M 6 x 18 DIN 931 (to fasten guide plate to crankcase)	2	
149	—	shake-proof (toothed) washer J 6,4 DIN 6797 k	2	
Valves with Drive				
150	1710 z 4	tappet	4	
151	192 z 2	tappet bushing	4	
152	1330 k 29	push rod, complete	4	
153	—	stud AM 8 x 15 DIN 835 (to fasten tappet bushing to crankcase)	2	
—	—	hex. nut M 8 DIN 934 k	2	
154	1301 z 407	safety washer	2	
155	710 z 2	rocker arm, left-hand	2	
156	710 z 3	rocker arm, right-hand	2	
157	121 z 48	rocker shaft	4	
158	1551 z 61	screw (to rocker arm)	4	
159	—	hex. nut M 8 x 1 DIN 936 k	4	

Illustration 7, Group M: d) Valve Drive, Camshaft and Valves

Key No.	Spare Part No.	Description	No. of Pieces	Remarks
160	1871 z 11	bearing needle	136	
161	1424 z 1	bearing	8	
162	1831 z 18	intake valve	2	
—	1831 z 19	exhaust valve	2	
163	321 z 93	inner valve spring	4	
164	321 z 94	outer valve spring	4	
165	1231 z 43	split collar ring	8	
166	1781 z 152	spring plate	4	

Illustration 8, Group M: e) Oil Pump

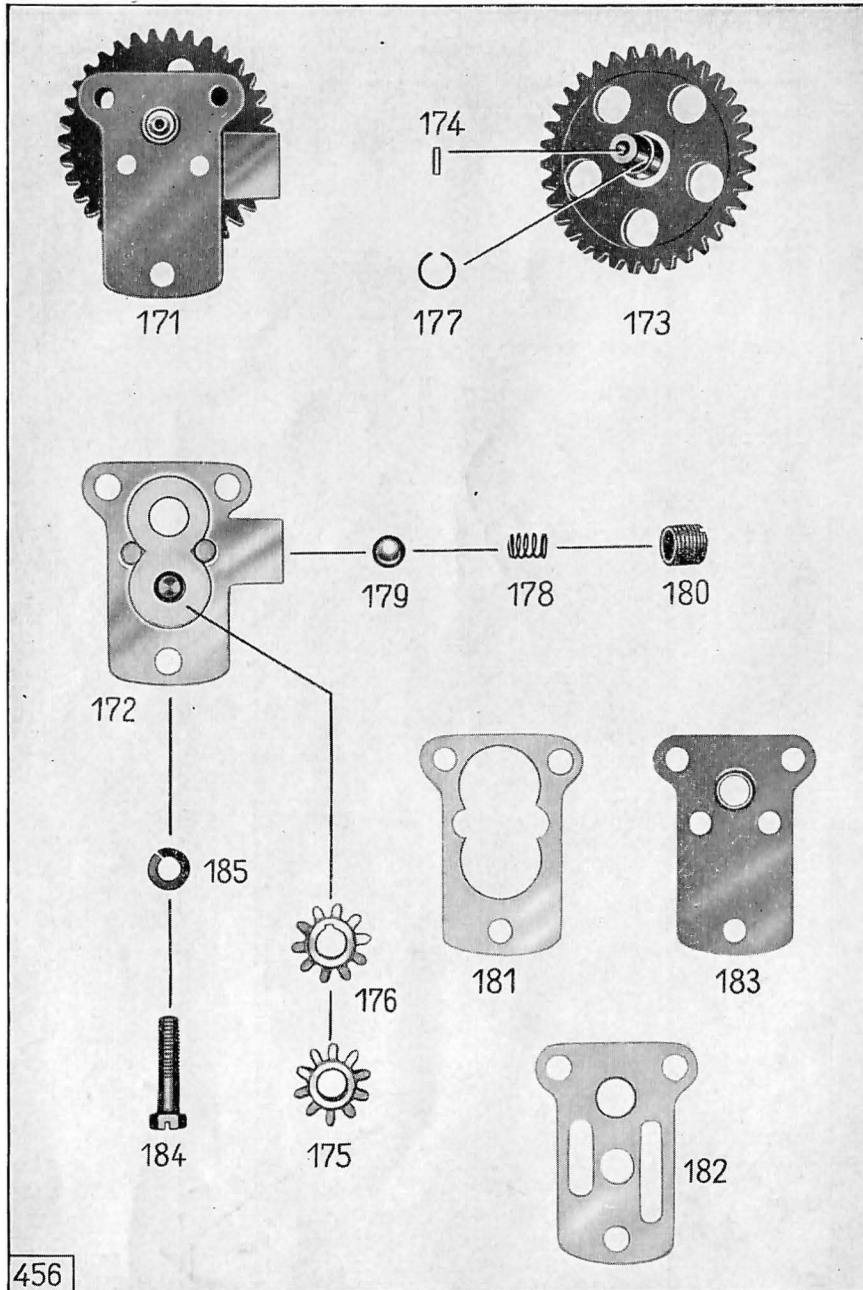

Illustration 8, Group M: e) Oil Pump

Key No.	Spare Part No.	Description	No. of Pieces	Remarks
Oil Pump				
171	6640 z 6	oil pump, complete	1	
172	480 z 28	oil pump housing	1	
173	2139 z 13	drive gear with shaft	1	
174	1691 z 8	cylindrical pin (to oil pump shaft)	1	
175	2131 z 51	oil pump gear (loose)	1	
176	2131 z 52	oil pump gear (stationary)	1	
177	1251 z 019	snap ring (to fasten oil pump gear to shaft)	1	
178	321 z 49	pressure regulating spring	1	
179	—	ball 10 mm III DIN 5401	1	
180	1561 z 021	pressure regulating screw	1	
181	468 z 58	gasket (between pump housing and bearing bracket)	1	
182	468 z 59	gasket (between bearing bracket and crankcase)	1	
183	1144 z 4	bearing bracket (between the gaskets)	1	
184	1551 z 4	hex. screw (to fasten oil pump to crankcase)	3	
185	—	spring washer A 8 DIN 127	3	

Illustration 9, Group M: f) Carburettors

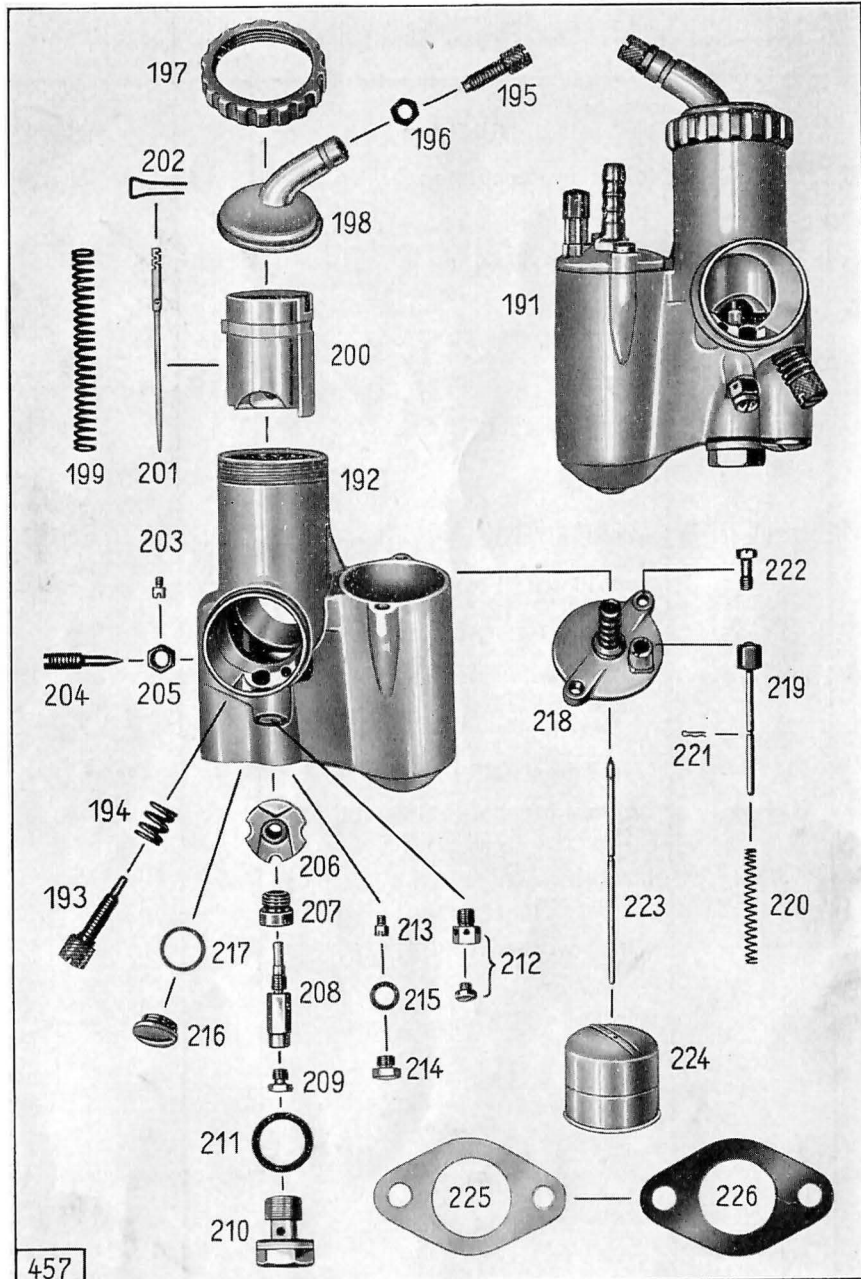

Illustration 9, Group M: f) Carburettors

Key No.	Spare Part No.	Description	No. of Pieces	Remarks
Carburettors				
—	6430 z 74	flange-type downdraft carburettor, left-hand (model Bing 1/25/3) . . .	1	
191	6430 z 75	flange-type downdraft carburettor, right-hand (model Bing 1/25/4) . . .	1	
192	2403 k 50	carburettor housing, left-hand . . .	1	
—	2403 k 57	carburettor housing, right-hand . . .	1	
193	2401 k 53	idle running adjusting screw	2	
194	2401 k 54	spring (to idle running adjusting screw)	2	
195	2401 k 5	throttle cable adjusting screw	2	
196	2401 k 6	nut (to throttle cable adjusting screw)	2	
197	2403 k 51	nut (to seal top)	2	
198	2403 k 52	carburettor top, left-hand	1	
—	2403 k 58	carburettor top, right-hand	1	
199	2401 k 52	slide spring	2	
200	2403 k 53	gas slide	2	
201	2401 k 55	jet needle	2	
202	2401 k 8	clip (to jet needle)	2	
203	2404 k 24	idle air jet	2	
204	2401 k 14	idle air screw	2	
205	2401 k 12	nut (to idle air screw)	2	
206	2403 k 54	mixing chamber insert (please quote also number cast into it, when ordering)	2	
207	2404 k 28	threaded piece (to fasten mixing chamber insert)	2	
208	2404 k 25	needle jet	2	

Illustration 9, Group M: f) Carburetors

Key No.	Spare Part No.	Description	No. of Pieces	Remarks
209	2404 k 26	main jet (please quote size when ordering)	2	
210	2403 k 55	end screw	2	
211	2407 k 7	gasket (to end screw)	2	
212	2401 k 59	protective screw	2	
213	2404 k 23	idling jet (please quote size when ordering)	2	
214	2401 k 51	lock screw (to idling jet)	2	
215	2407 k 6	gasket (to lock screw)	2	
216	2401 k 60	lock screw (to compensating chamber)	2	
217	2407 k 8	gasket (to lock screw)	2	
218	2403 k 56	float chamber cover with swivel-type pipe connector	2	
219	2401 k 56	tickler	2	
220	2401 k 57	tickler spring	2	
221	2401 k 19	split pin	2	
222	2401 k 61	set screw	4	
223	2401 k 58	float needle	2	
224	2404 k 27	float	2	
225	468 z 60	flange gasket	4	
226	466 z 65	separator plate	2	

Illustration 10, Group M: f) Carburetors, Air Cleaner and Suction Manifold

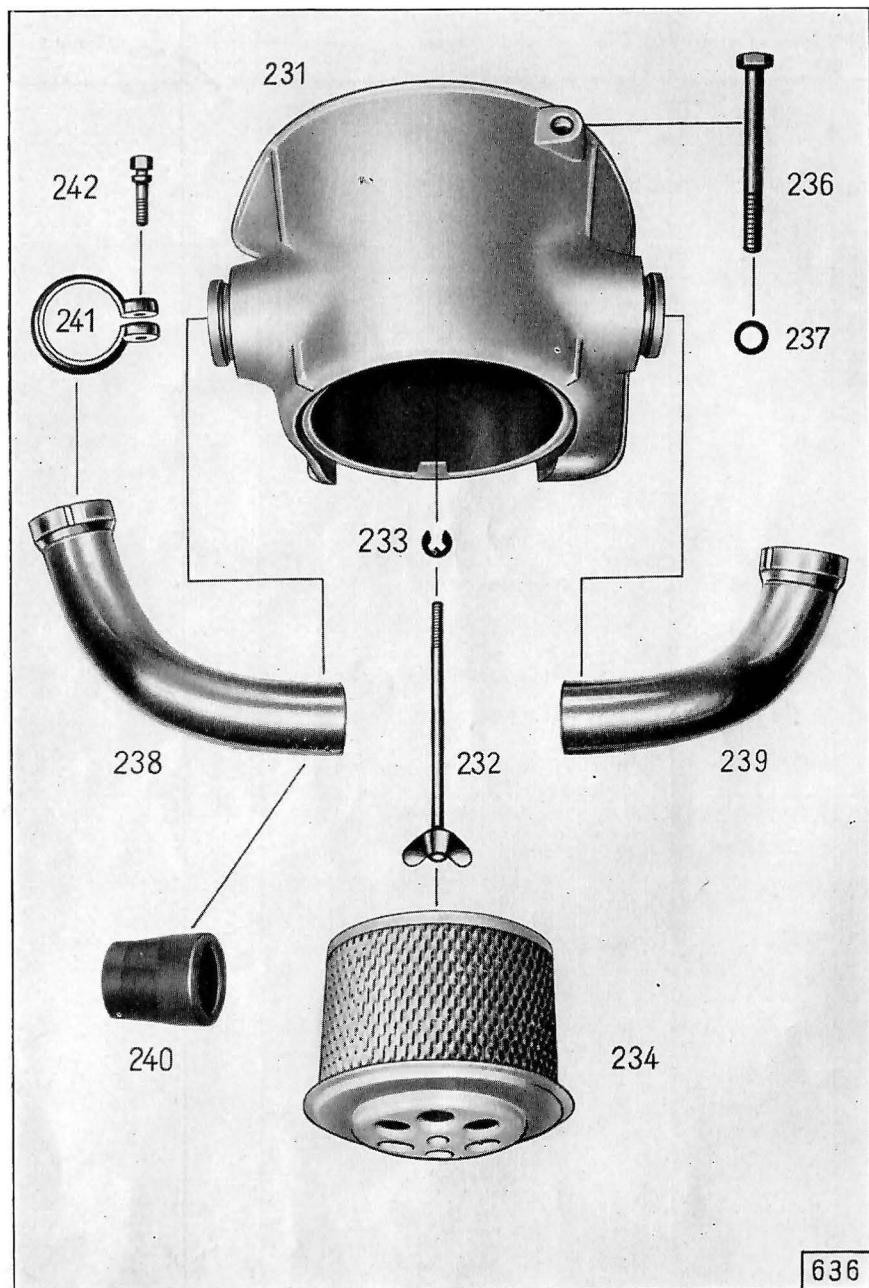

636

Illustration 10, Group M: f) Carburetors, Air Cleaner and Suction Manifold

Key No.	Spare Part No.	Description	No. of Pieces	Remarks
Air Cleaner				
231	483 z 76	air cleaner housing (for suction pipes of 36 mm ø) . . .	1	
232	1560 z 5	stud (to fasten air cleaner)	1	
233	—	C-washer 5 DIN 6799 k	1	
234	6410 z 208	air filter	1	
236	—	hex. screw M 8 x 80 DIN 931 k (to fasten air cleaner housing to gearbox)	1	
237	—	washer 8,4 DIN 125 k	1	
Suction Manifold				
238	1341 z 91	suction pipe, left-hand (36 mm ø) .	1	
239	1341 z 92	suction pipe, right-hand (36 mm ø)	1	
240	616 z 205	rubber sleeve (to fasten suction pipes of 36 mm ø to air cleaner housing)	2	
241	1231 z 29	clamp (to fasten suction pipes to carburettor)	2	
242	1551 z 75	screw (to clamp)	2	

Illustration 11, Group M: g) Clutch, Clutch, Clutch Operating Mechanism

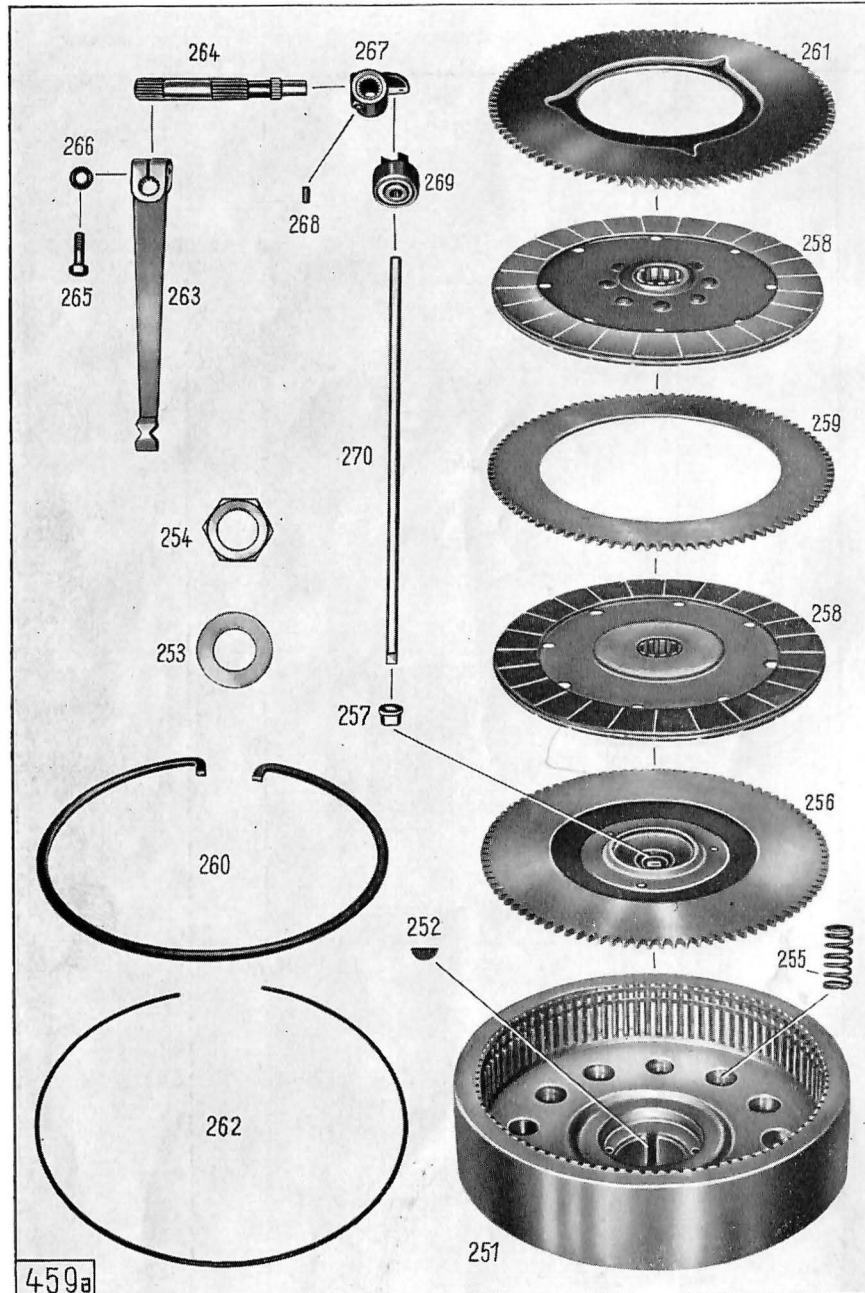

Illustration 11, Group M: g) Clutch, Clutch, Clutch Operating Mechanism

Key No.	Spare Part No.	Description	No. of Pieces	Remarks
Clutch				
251	1311 z 13	flywheel	1	
252	—	woodruff key 5 x 6,5 DIN 6888 (to crankshaft)	1	
253	1291 z 6	safety washer (to be flapped around undermentioned nut)	1	
254	1001 z 25	nut (to fasten flywheel to crankshaft)	1	
255	321 z 151	clutch spring	12	
256	920 z 50	clutch pressure plate.	1	
257	1121 z 31	pressure pin	1	
258	920 z 49	clutch disc	2	
259	921 z 72	clutch center plate	1	
260	1251 z 03	snap ring	1	
261	921 z 205	clutch cover plate	1	
262	1251 z 04	spring washer	1	
Clutch Operating Mechanism				
263	671 z 342	clutch lever	1	
264	1941 z 95	clutch shaft	1	
265	—	hex. screw M 6 x 20 DIN 931 k (to fasten clutch lever to clutch shaft)	1	
266	—	washer 6,4 DIN 125 k	1	
267	671 z 169	pressure lever	1	
268	—	pin 4 x 8 DIN 1471 (to fasten pressure lever to clutch shaft)	1	
269	6840 z 43	thrust bearing, complete	1	
270	1651 z 179	clutch push rod	1	

Illustration 12, Group G: a) Change-Speed Gear Unit, b) Gear-Set Case

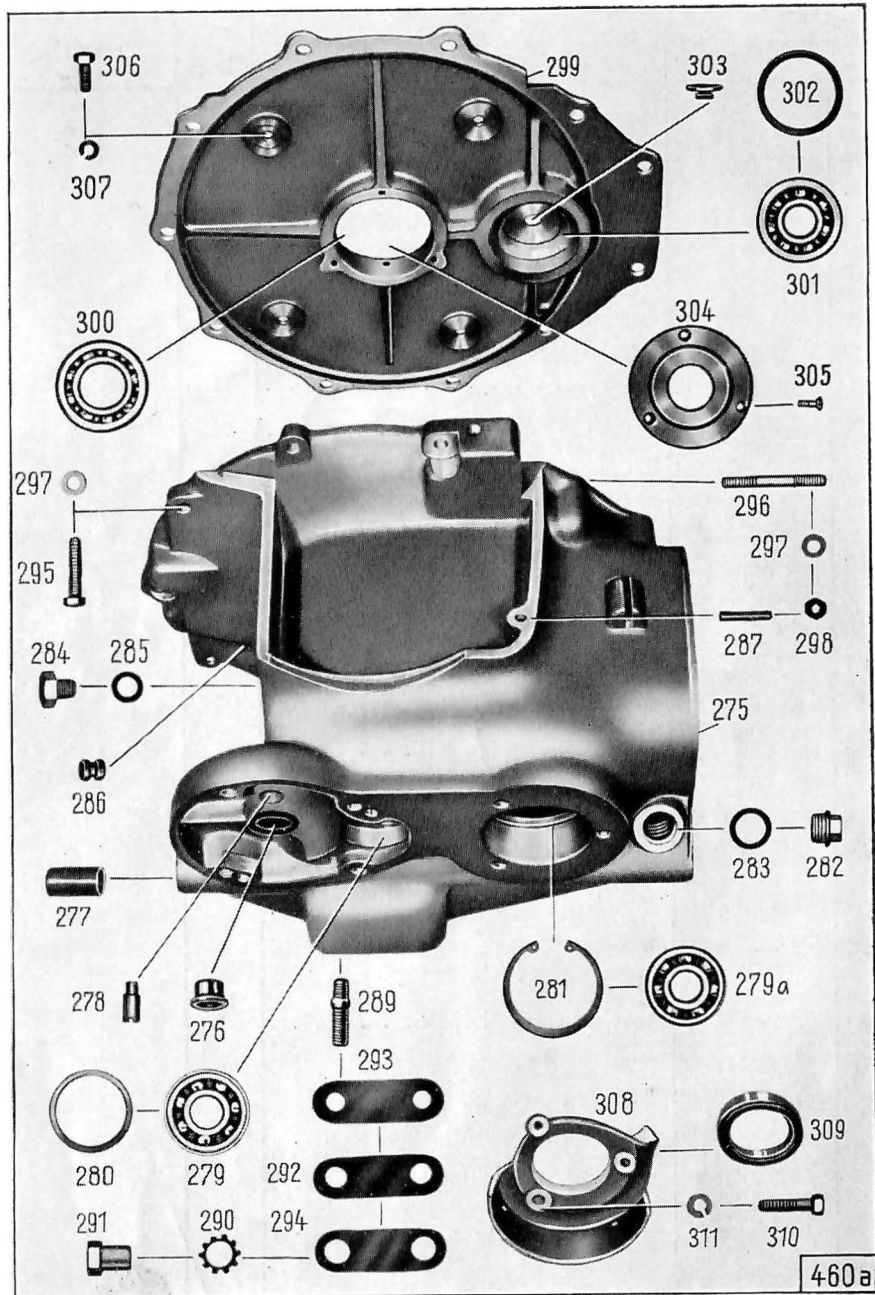

Illustration 12, Group G: a) Change-Speed Gear Unit, b) Gear-Set Case

Key No.	Spare Part No.	Description	No. of Pieces	Remarks
Change-Speed Gear Unit				
—	6470 k 47	change-speed gear unit, complete	1	
Gear-Set Case				
275	490 k 31	gear-set case with bushings . . .	1	
276	182 z 5	bushing (for starter shaft)	1	
277	184 z 75	bushing (for footshift shaft) . . .	2	
278	1541 z 04	stop bolt (to starter gear)	1	
279	—	ball bearing 6303 DIN 625 (to transmission main shaft) . . .	1	
279a	—	ball bearing 6205 C 3 DIN 625 (to layshaft)	1	
280	1301 z 061	spacer washer	} as re-quired	
—	1301 z 062	spacer washer		
—	1301 z 063	spacer washer		
281	—	circlip 52 x 2 DIN 472 (to ball bearing of layshaft with gear-set case without collar)	1	
282	1551 z 010	oil filler screw (for oil in gearbox)	1	
283	—	packing washer A 18 x 24 DIN 7603 (to oil filler screw)	1	
284	—	hex. screw M 12 x 1,5 x 10 DIN 960 k (for oil draining)	1	
285	—	packing washer A 12 x 18 DIN 7603 (to hex. screw)	1	
286	1806 z 37	rubber grommet	1	
287	—	pin 5 x 18 DIN 1474 (to fasten air cleaner housing to gear-set case)	1	
289	—	stud M 10 x 25 DIN 939 (to fasten gear-set to frame)	2	

Illustration 12, Group G: b) Gear-Set Case

Key No.	Spare Part No.	Description	No. of Pieces	Remarks
290	—	shake-proof (toothed) washer A 14,5 DIN 6797 k	2	
291	1001 z 81	recessed nut	2	
292	1146 z 16	rubber plate (between gear-set and frame)	2	
293	1141 z 1463	bracket	1	
294	1141 z 1464	bracket	1	
295	—	hex. screw M 7 x 35 DIN 933 k (to fasten gear-set to crankcase) . .	8	
296	—	stud M 7 x 38 DIN 940 k (to fasten gear-set case to crankcase) . .	3	
297	—	washer 7,4 DIN 125 k	11	
298	—	hex. nut M 7 DIN 934 k	3	
—	—	washer 7 DIN 126 k	1	
299	243 z 20	gear-set case cover	1	
300	—	ball bearing 6205 Z DIN 625 (in gear-set case cover for transmission main shaft)	1	
301	—	ball bearing 6303 DIN 625 (in gear- set case cover for layshaft) . .	1	
302	1301 z 061	spacer washer	} as re- quired	
—	1301 z 062	spacer washer		
—	1301 z 063	spacer washer		
303	1541 z 150	lock screw	1	
304	1281 z 245	sealing plate	1	
305	—	screw, countersunk raised head, AM 4 x 12 DIN 91 (to fasten sealing plate to gear-set case cover)	3	
306	—	hex. screw M 6 x 15 DIN 933 k (to fasten gear-set case cover to gear-set case)	4	

Illustration 12, Group G: b) Gear-Set Case

Key No.	Spare Part No.	Description	No. of Pieces	Remarks
307	—	spring washer A 6 DIN 127 k . . .	4	
308	783 z 21	rear end drive protective cap . .	1	
309	6860 z 83	packing ring	1	
310	—	hex. screw M 7 x 20 DIN 933 k (to fasten rear end drive pro- tective cap to gear-set case) . .	3	
311	—	washer 7,4 DIN 125 k	3	
—	1143 z 106	covering plate (to rear end drive protective cap)	1	
—	—	hex. screw M 5 x 6 DIN 933 k . . .	2	
—	—	shake-proof (toothed) washer J 5,3 DIN 6797 k	2	

Illustration 13, Group G: c) Shafts and Chain Drive Gears

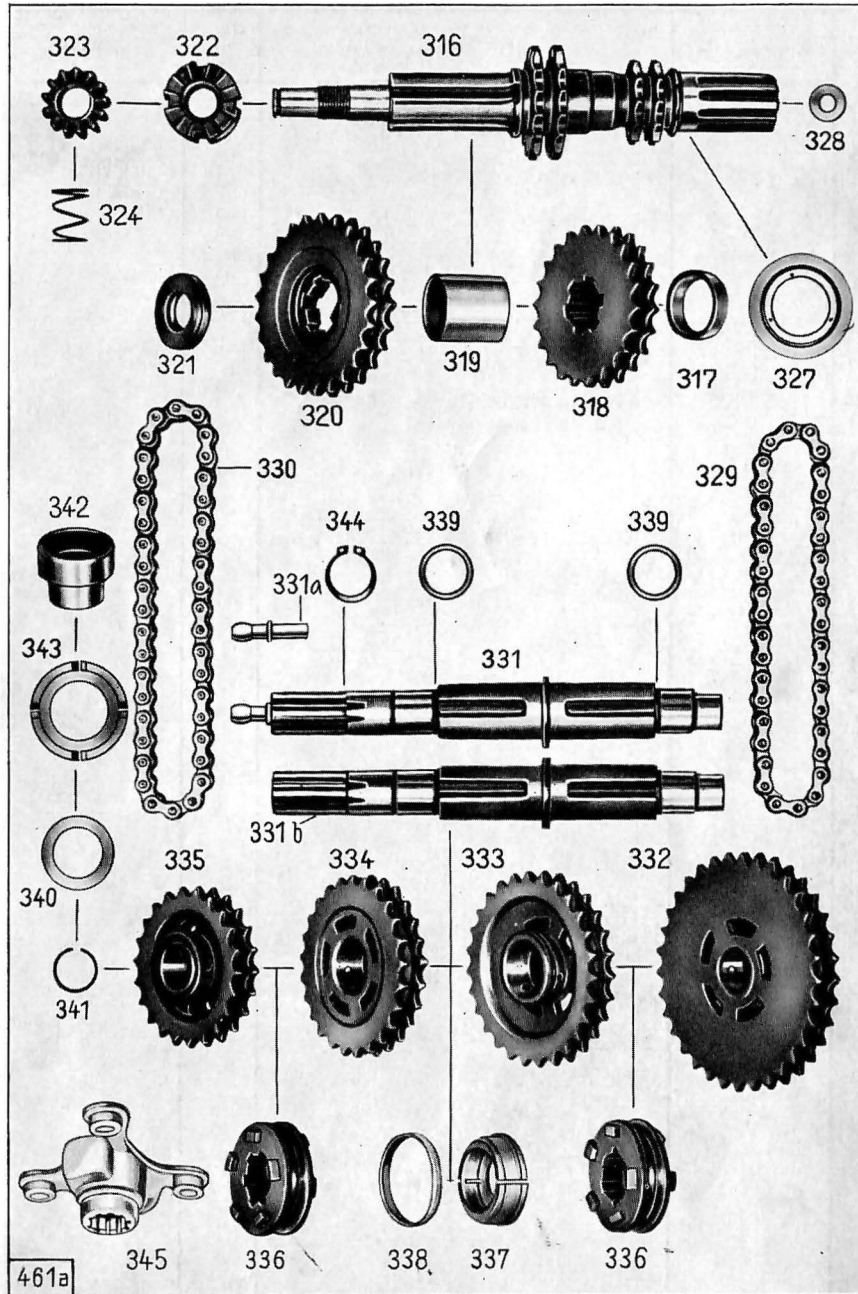

Illustration 13, Group G: c) Shafts and Chain Drive Gears

Key No.	Spare Part No.	Description	No. of Pieces	Remarks
Shafts and Chain Drive Gears				
316	1941 z 99	transmission main shaft	1	
317	1241 z 03	short distance tube (between chain drive gears 2nd and 3rd speed)	1	
318	2111 z 39	chain drive gear 3rd speed (21 teeth)	1	
319	1241 z 48	long distance tube (between chain drive gears 3rd and 4th speed)	1	
320	2111 z 38	chain drive gear 4th speed (26 teeth)	1	
321	1231 z 03	spacer ring (between chain drive gear 4th speed and ball bearing)	1	
322	961 z 210	nut (to transmission main shaft gear)	1	
323	2131 z 314	transmission main shaft gear	1	
324	321 z 570	pressure spring	1	
327	1281 z 236	washer	1	
328	1236 z 216	felt ring (to clutch push rod in transmission main shaft)	1	
329	6240 z 30	two-strand chain, 38 links	1	2nd speed
330	6240 z 31	two-strand chain, 40 links	2	1st and 3rd speed
—	6240 z 103	two-strand chain, 42 links	1	4th speed
331	1940 z 210	layshaft (counter-shaft), matching with elastic connecting disc (make Vulkollan)	1	
331a	121 z 1134	ball bolt	1	
331b	1941 z 314-6	layshaft (counter-shaft), matching with universal joint	1	
332	2110 z 01	chain drive gear 1st speed (33 teeth)	1	

Illustration 13, Group G: c) Shafts and Chain Drive Gears

Key No.	Spare Part No.	Description	No. of Pieces	Remarks
333	2111 z 37	chain drive gear 2nd speed (26 teeth)	1	
334	2111 z 37	chain drive gear 3rd speed (26 teeth)	1	
335	2110 z 19	chain drive gear 4th speed (25 teeth)	1	
336	961 z 31	sliding jaw	2	
337	1231 z 04	two-piece ring (for connecting 2nd and 3rd speed gears)	1	
338	1231 z 05	retaining ring (to two-piece ring)	1	
339	1301 z 205	washer (to 1st and 4th speed gears and on layshaft)	2	
340	1281 z 237	washer (to 4th speed gear, rear part)	1	
341	1251 z 164	snap ring (between above washer and 4th speed gear)	1	
342	181 z 116	spacer bushing	1	
—	—	ball 3,5 mm IV DIN 5401	2	
343	1281 z 246	washer (on spacer bushing) . . .	1	
344	—	circlip 20 x 1,2 DIN 471 (to spacer bushing)	1	
—	1301 z 425	covering washer (to ball bearing)	1-2	
—	1301 z 426	spacer washer	1-2	
345	961 z 216	connecting member	1	

Illustration 14, Group G: d) Footshift Mechanism

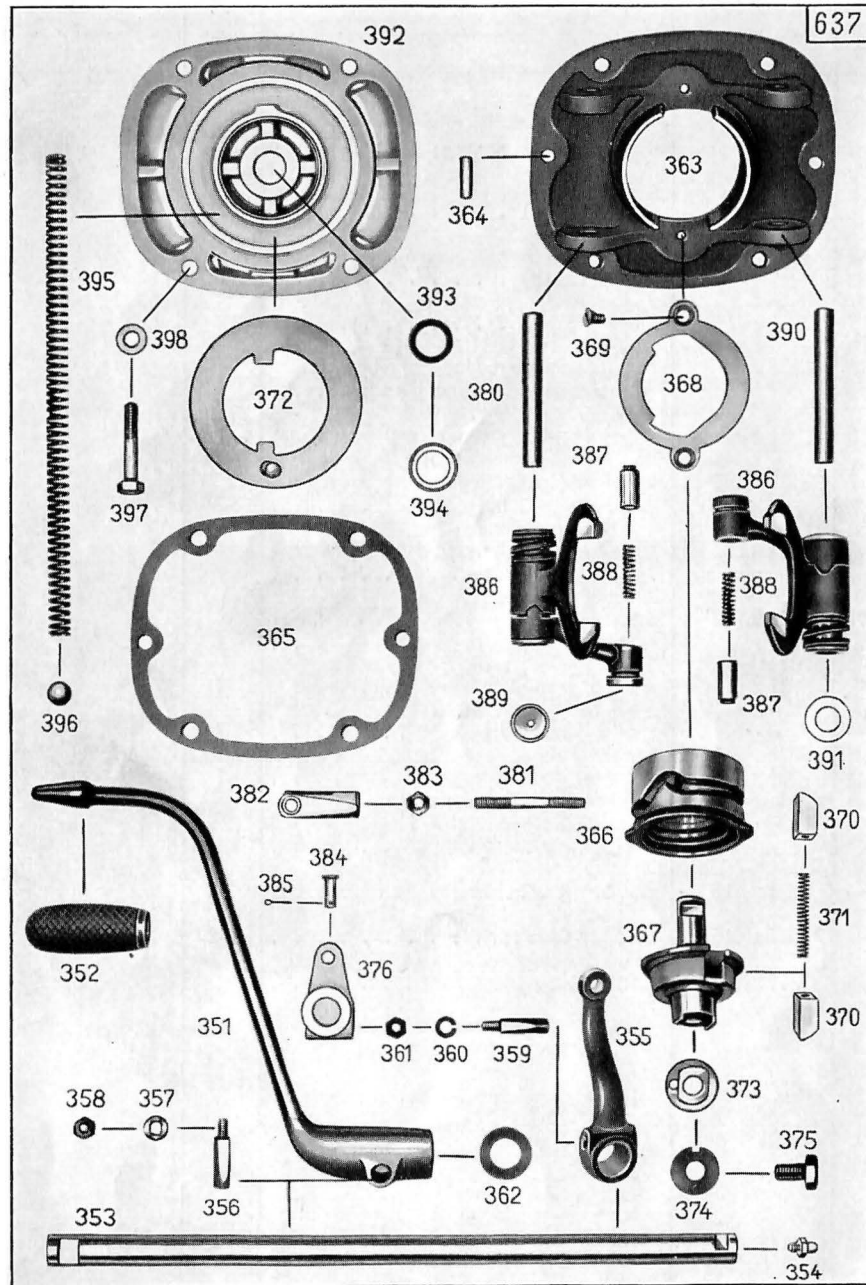

Illustration 14, Group G: d) Footshift Mechanism

Key No.	Spare Part No.	Description	No. of Pieces	Remarks
Footshift Mechanism				
351	701 z 18	footshift lever	1	
352	616 z 25	rubber sleeve	1	
353	1921 z 14	footshift shaft	1	
354	1080 z 1	grease nipple (on footshift shaft) .	1	
355	681 z 18	gear shift lever (on footshift shaft)	1	
356	121 z 1008	cotter pin (to fasten footshift lever to footshift shaft)	1	
357	—	spring washer B 5 DIN 137 k	2	
358	—	hex. nut M 5 DIN 934 k	1	
359	121 z 1009	cotter pin (to fasten gear shift lever to footshift shaft)	1	
360	—	spring washer A 5 DIN 127 k	1	
361	—	hex. nut M 5 DIN 934 k	1	
362	1236 z 61	rubber ring (between gear shift lever and gear-set case)	1	
Gear Shift Mechanism				
—	6510 k 10	foot gear shift set, complete	1	
363	232 z 2	intermediate cover	1	
364	—	cylindrical pin 6 m6 x 18 DIN 7 (to intermediate cover in gear-set case)	2	
365	468 z 63	gasket (between gear-set case and intermediate cover)	2	
366	1101 z 101	gear shift cam	1	
367	1941 z 36	gear shift shaft	1	
368	201 z 9	guiding piece	1	
369	—	screw, countersunk head, M 5 x 8 DIN 63 k (to fasten guiding piece to intermediate cover)	2	

Illustration 14, Group G: d) Footshift Mechanism

Key No.	Spare Part No.	Description	No. of Pieces	Remarks
370	841 z 7	ratchet (in gear shift shaft)	2	
371	321 z 501	pressure spring (between the ratchets)	1	
372	200 z 5	guiding piece	1	
373	1291 z 20	washer	1	
374	—	safety washer 8,4 DIN 432	1	
375	1551 z 96	screw (to fasten gear shift cam to gear shift shaft)	1	
376	681 z 23	gear shift lever (on gear shift shaft)	1	
359	121 z 1009	cotter pin (to fasten gear shift lever to gear shift shaft)	1	
360	—	spring washer A 5 DIN 127 k	1	
361	—	hex. nut M 5 DIN 934 k	1	
381	1651 z 301	gear shift rod	1	
382	551 z 102	connecting clip (to gear shift rod)	2	
383	—	hex. nut M 6 DIN 934 k	2	
384	131 z 505	bolt (to fasten gear shift rod to gear shift lever)	2	
385	—	split pin 1,5 x 10 DIN 94 k	2	
386	710 z 10	gear shift fork, complete	2	
387	1331 z 719	pin (within lever for gear shift fork)	2	
388	321 z 515	pressure spring (to above pin)	2	
—	—	ball 6 mm III DIN 5401	2	
389	781 z 79	cap (to gear shift fork)	2	
390	121 z 68	pin (to fasten gearshift fork to intermediate cover)	2	

Illustration 14, Group G: d) Footshift Mechanism

Key No.	Spare Part No.	Description	No. of Pieces	Remarks
391	1301 z 142	spacer washer	} as required	
—	1301 z 610	spacer washer		
—	1301 z 611	spacer washer		
392	233 z 95	cover	1	
393	1236 z 96	packing washer (in above cover)	1	
394	781 z 80	sealing cap (to packing washer)	1	
395	321 z 70	pressure spring	1	
396	—	ball 12 mm IV DIN 5401	2	
397	—	hex. screw M 7 x 35 DIN 933 k (to fasten cover to gear-set case)	4	
398	—	washer 7,4 DIN 125 k	4	

Illustration 15, Group G: e) Kickstarter

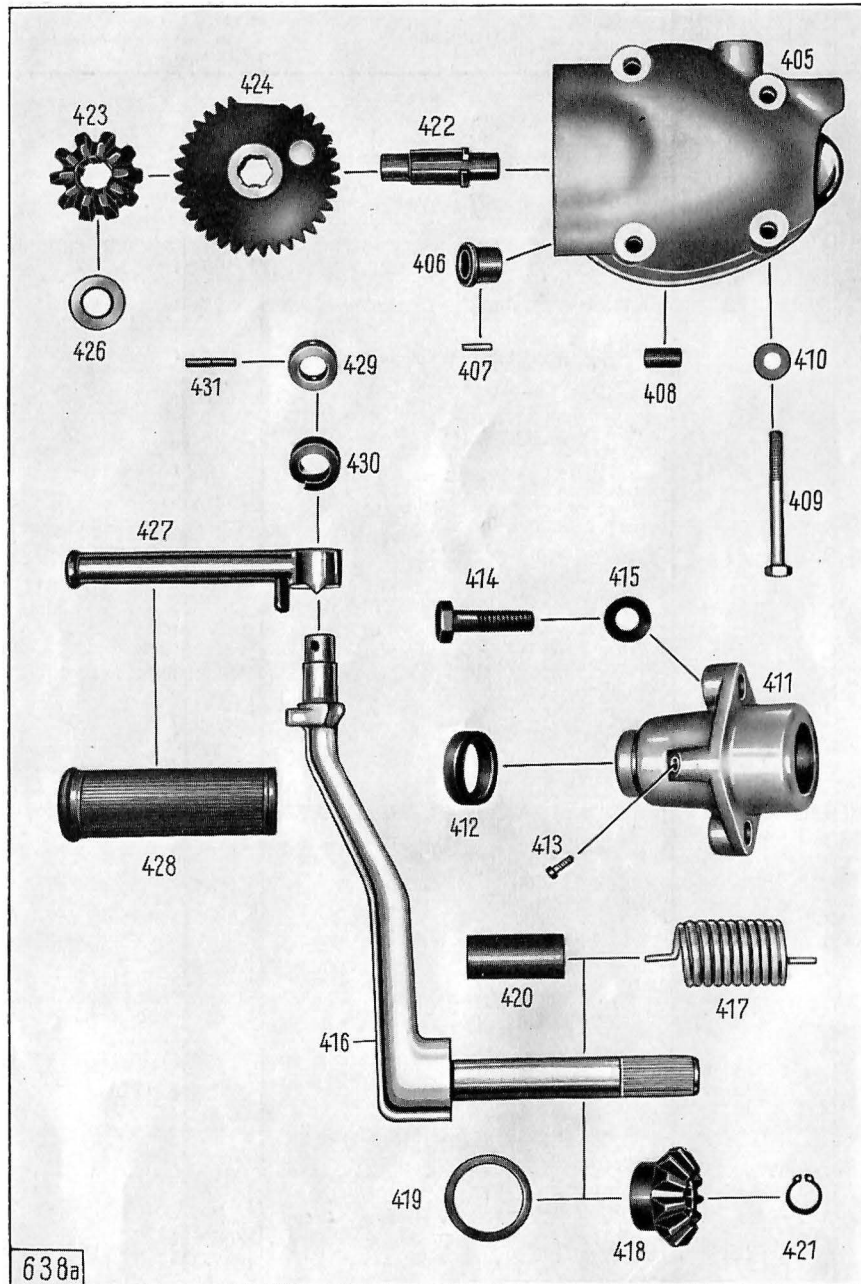

Illustration 15, Group G: e) Kickstarter

Key No.	Spare Part No.	Description	No. of Pieces	Remarks
Kickstarter				
405	230 k 241	kickstarter cover, complete	1	
406	182 z 6	bushing (to kickstarter cover)	1	
407	—	pin 3 x 10 DIN 1471	1	
408	—	pin 8 x 16 DIN 1481 (to kickstarter cover on gear-set case)	2	
409	—	hex. screw M 7 x 55 DIN 931 k (to fasten kickstarter cover to gear-set case)	4	
410	—	washer 7,4 DIN 125 k	4	
411	480 k 411	kickstarter lever bearing	1	
412	1236 z 301	packing washer	1	
413	—	hex. screw M 6 x 10 DIN 933 k	1	
414	—	hex. screw M 10 x 35 DIN 931 k (to fasten kickstarter lever bearing to gear-set case)	2	
415	—	washer 10,5 DIN 433 k	2	
416	900 z 16	kickstarter lever with shaft	1	
417	321 z 90	kickstarter spring	1	
418	2091 z 13	bevel gear (on kickstarter lever)	1	
419	1301 z 018	spacer washer (between bevel gear and kickstarter lever bearing)	1	as required
420	171 z 18	spacer bushing (on kickstarter lever)	1	
421	—	circlip 14 x 1 DIN 471 (to fasten bevel gear onto kickstarter lever)	1	
422	1921 z 01	kickstarter shaft	1	
423	2091 z 02	bevel gear (on kickstarter shaft)	1	
424	2130 z 11	starter gear (on kickstarter shaft)	1	
426	1301 z 01	spacer washer	between starter gear and gear-set case	as required
—	1301 z 03	spacer washer		

Illustration 15, Group G: e) Kickstarter

Key No.	Spare Part No.	Description	No. of Pieces	Remarks
427	131 z 504	kickstarter foot piece	1	
428	616 z 01	rubber sleeve (to foot piece) . . .	1	
429	1231 z 215	fixing ring (to fasten foot piece to kickstarter lever)	1	
430	1251 z 253	double spring washer	1	
431	—	pin 4 x 22 DIN 1471 k	1	

Illustration 16, Group H: a) Rear End Drive Gear Unit (Assembly)

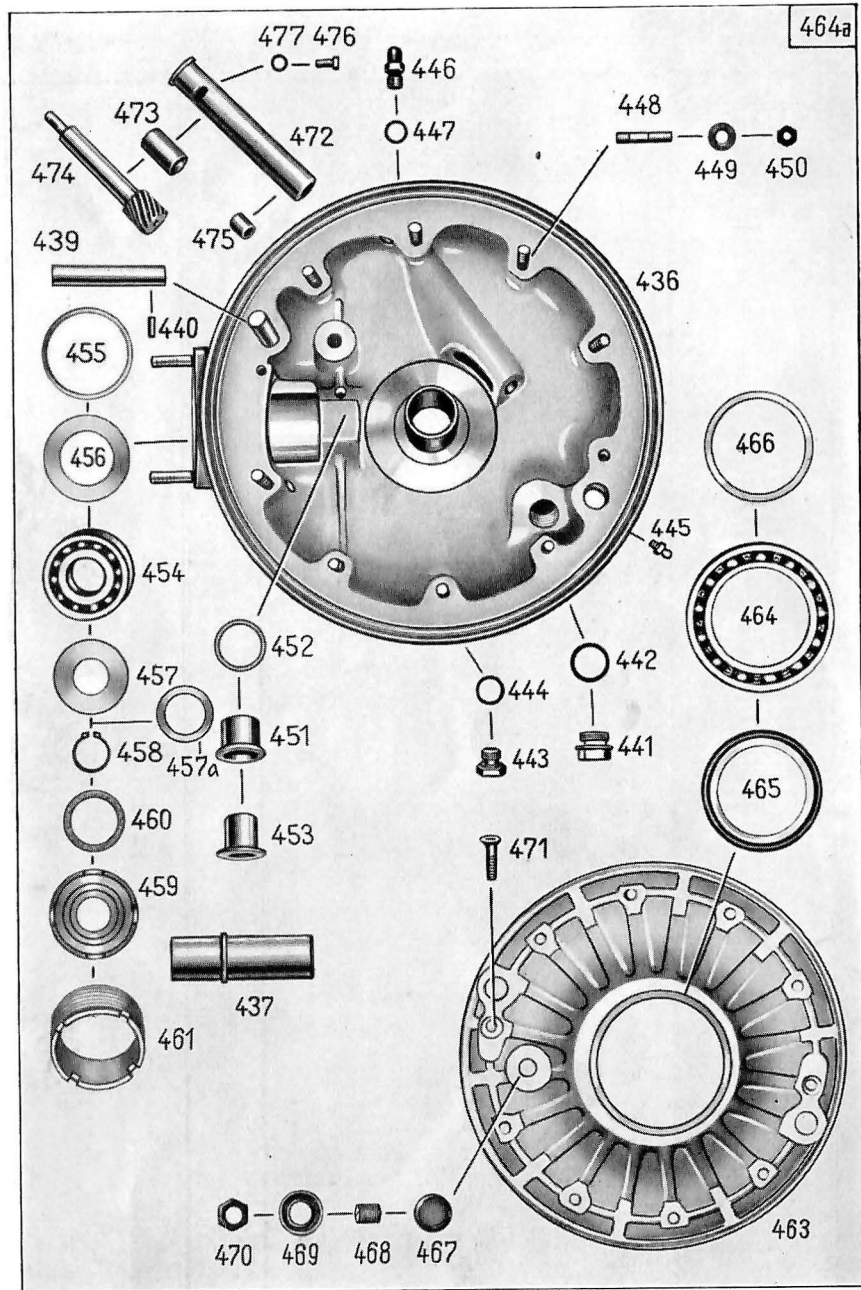

Illustration 16, Group H: a) Rear End Drive Gear Unit (Assembly)

Key No.	Spare Part No.	Description	No. of Pieces	Remarks
Rear End Drive Gear Unit				
—	6500 k 51	rear end drive unit, complete, for solo work (gear ratio 8:39)	1	
Rear End Drive Housing with Cover				
436	500 z 14	rear end drive housing	1	
—	1561 z 210	stud (to fasten right-h. swinging arm to rear end drive housing)	2	
—	—	cap nut M 12 x 1,5 DIN 1587 k	2	
—	—	spring washer A 12 DIN 127 k	2	
—	1283 z 102	shim	as required	
437	181 z 331	shaft bushing	1	
—	—	pin 4 x 8 DIN 1471 (to fasten shaft bushing in rear end drive housing)	1	
439	1331 z 591	supporting tube	1	
440	—	pin 3 x 14 DIN 1473 (to fasten supporting tube in rear end drive housing)	1	
441	—	lock screw AM 18 x 1,5 DIN 7604 (for oil filling hole)	1	
442	—	packing washer A 18 x 24 DIN 7603	1	
443	—	lock screw AM 12 x 1,5 DIN 7604 (for oil draining hole)	1	
444	—	packing washer A 12 x 18 DIN 7603	1	
445	1080 z 1	grease nipple	1	
—	—	packing washer A 6 x 10 DIN 7603	1	
446	1550 z 20	breather screw	1	
447	—	packing washer A 10 x 14 DIN 7603	1	
448	—	stud M 7 x 25 DIN 939 k (to fasten cover to rear end drive housing)	8	
449	1301 z 420	safety washer	8	
450	—	hex. nut M 7 DIN 934 k	8	
451	184 z 322	bushing with collar (for bevel drive pinion bearing)	1	

Illustration 16, Group H: b) Rear End Drive Housing with Cover

Key No.	Spare Part No.	Description	No. of Pieces	Remarks
452	1301 z 421	spacer washer 0,1 mm	} as re-quired	
—	1301 z 422	spacer washer 0,3 mm		
—	1301 z 423	spacer washer 0,5 mm		
453	181 z 125	bushing with collar, thickness of collar 2,6 mm	} as re-quired	mounted in bushing No. 184 z 322 in a floating position
—	181 z 126	bushing with collar, thickness of collar 2,5 mm		
—	181 z 127	bushing with collar, thickness of collar 2,4 mm		
454	—	tapered ball bearing 3304 x DIN 628 C 4 (to bevel drive pinion)	1	
455	1301 z 400	spacer washer 0,1 mm	} as re-quired	
—	1301 z 399	spacer washer 0,2 mm		
—	1301 z 398	spacer washer 0,3 mm		
456	1301 z 411	covering washer 0,2 mm (between spacer washer and tapered ball bearing)	1	
457	1301 z 424	covering washer (to tapered ball bearing)	1	
457a	1301 z 042	spacer washer	} as re-quired	
—	1301 z 629	spacer washer		
458	—	circlip 20 x 1,2 DIN 471 (to fasten tapered ball bearing onto bevel drive pinion)	1	
459	1281 z 247	thrust washer	1	
460	1236 z 221	felt ring (within thrust washer)	1	
461	991 z 206	retaining nut (to fasten tapered ball bearing in rear end drive housing)	1	

Illustration 16, Group H: b) Rear End Drive Housing with Cover

Key No.	Spare Part No.	Description	No. of Pieces	Remarks
463	253 z 13	housing cover	1	
464	—	ball bearing 6011 x DIN 625 C 3	1	
465	—	packing ring B 55 x 70 x 8 DIN 6503	1	
466	1301 z 413	spacer washer 0,1 mm	} as re-quired	between ball bearing and hub shell
—	1301 z 414	spacer washer 0,3 mm		
—	1301 z 415	spacer washer 0,5 mm		
467	1124 z 7	supporting piece (mushroom-shaped)	1	
468	1561 z 07	adjusting screw	1	
469	1291 z 01	safety washer	1	
470	1001 z 04	hex. nut	1	
—	468 z 191	gasket (between housing cover and housing)	1	
471	1541 z 161	screw, countersunk head (to fasten housing cover to housing)	2	
472	180 z 19	bearing bushing, complete (for speedometer drive)	1	
473	—	not mounted with model KS 601 El.	—	
474	2121 z 28	screw pinion	1	
475	1124 z 6	small supporting piece (mushroom-shaped)	1	
476	—	hex. screw M 4 x 8 DIN 933 k (to fasten bearing bushing in rear end drive housing)	1	
477	—	packing washer A 4 x 8 DIN 7603	1	
—	—	stud M 10 x 50 DIN 940 k (to fasten spring unit to rear end drive housing)	1	
—	1301 z 162	washer	2	
—	—	spring washer A 10 DIN 127 k	1	
—	—	hex. nut M 10 DIN 934 k	1	

Illustration 17, Group H: c) Shaft Drive Unit

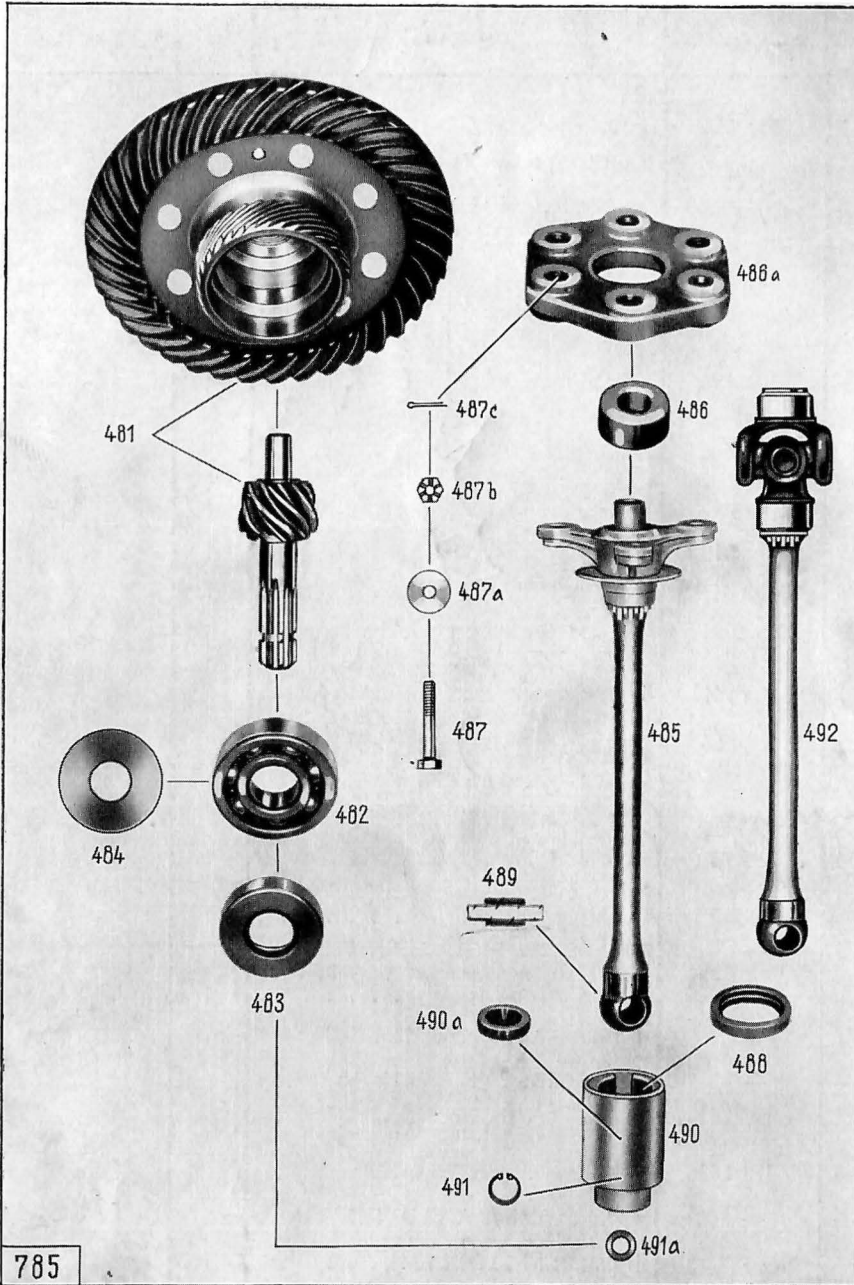

Illustration 17, Group H: c) Shaft Drive Unit

Key No.	Spare Part No.	Description	No. of Pieces	Remarks
Shaft Drive Unit				
481	480 z 408	hub shell with helical bevel ring gear and drive pinion, for solo-work (gear ratio 8:39)	1	
482	—	ball bearing 6305 DIN 625	1	
483	—	packing ring B 25 x 52 x 12 DIN 6503	1	
484	1301 z 393	spacer washer 0,1 mm	} as required	
—	1301 z 394	spacer washer 0,3 mm (between hub shell and rear end drive housing)		
—	1301 z 395	spacer washer 0,5 mm		
485	1930 k 87	drive shaft (matching to elastic connecting disc, make Vulkollan)	1	
486	1236 z 346	packing ring	1	
486a	1280 z 105	elastic connecting disc (make Vulkollan)	1	
487	—	hex. screw M 7 x 38 S DIN 931 k (to fasten connecting disc to connecting member)	6	
487a	1301 z 1040	washer	6	
487b	—	castle nut M 7 DIN 937 k	6	
487c	—	split pin 1,5 x 15 DIN 94 k	6	
488	6860 k 202	radial gasket (oil seal)	1	
489	124 z 102	pin (to drive shaft joint)	1	
490	960 z 106	rear connecting member	1	
490a	1304 z 39	washer	1	
491	—	circlip 16 x 1 DIN 472 (in rear connecting member)	1	
491a	1301 z 344	washer	as required	
—	1930 k 91-0	drive shaft with universal joint and layshaft	1	
492	1930 k 92-0	drive shaft with universal joint	1	

Illustration 18, Group R: a) Frame

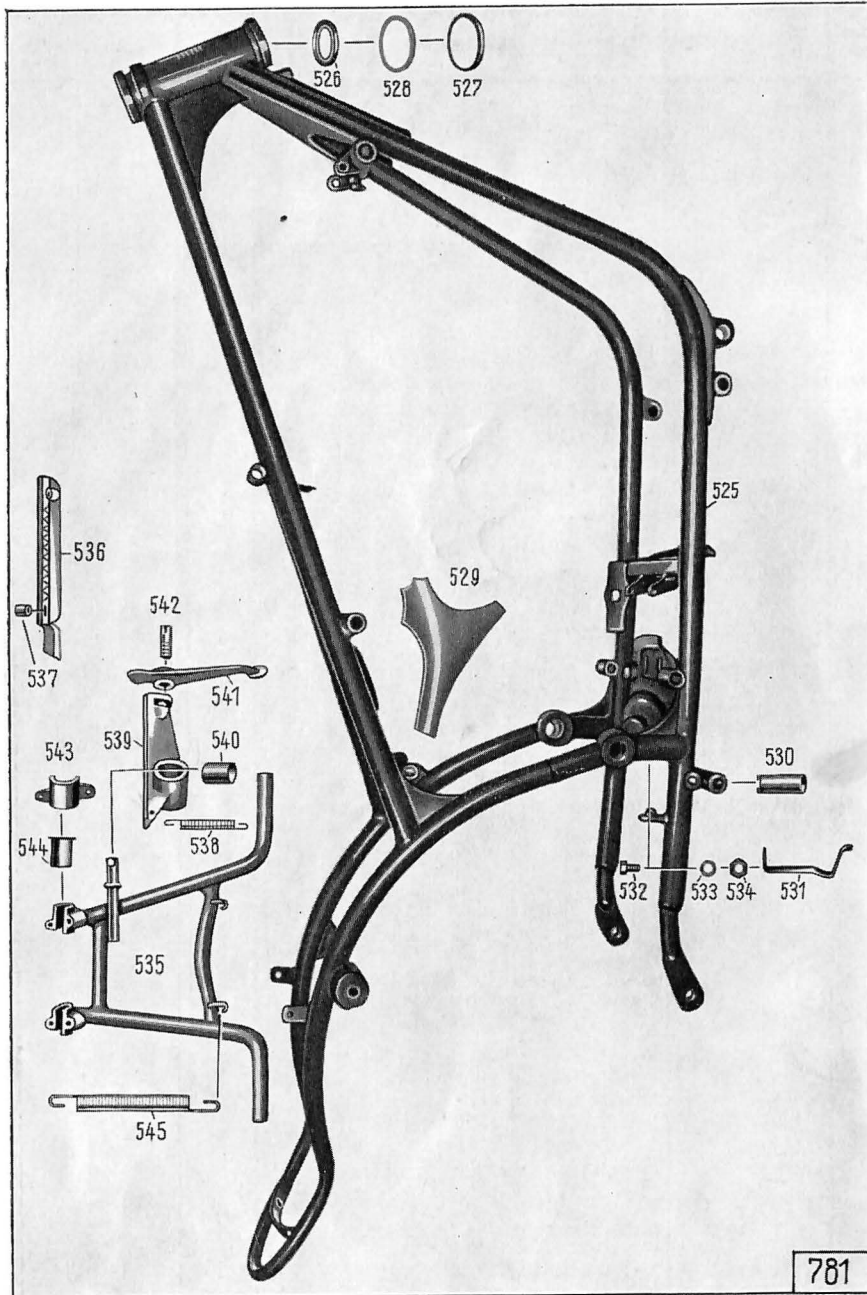

Illustration 18, Group R: a) Frame

Key No.	Spare Part No.	Description	No. of Pieces	Remarks
Frame				
525	6690 z 327	frame	1	
526	1871 z 171	frame race	2	
527	1231 z 210	covering washer (to frame race)	1	
528	1236 z 218	packing washer (to frame race)	1	
—	651 k 272-8	sheeting, left-hand	1	
529	651 z 273-8	sheeting, right-hand	1	
530	183 z 42	bushing (to foot brake lever)	2	
—	—	grease nipple D 6 DIN 71412	1	
531	331 z 140	retaining spring (to center stand on frame)	1	
532	—	hex. screw M 6 x 12 DIN 933 k (to fasten retaining spring to frame)	1	
533	—	spring washer A 6 DIN 127 k	1	
534	—	hex. nut M 6 DIN 934 k	1	
535	1750 z 203	center stand	1	
536	631 z 506	screen (for ratchets)	1	
537	171 z 405	distance sleeve	1	
—	—	hex. screw M 8 x 28 DIN 931 k (to fasten screen to frame)	1	
—	—	spring washer A 8 DIN 127 k	1	
—	—	screw, countersunk head, AM 8 x 18 DIN 87 k (to fasten screen to frame)	1	
—	—	shake-proof (toothed) washer A 8,4 DIN 6797 k	1	
—	—	hex. nut M 8 DIN 934 k	1	
538	321 z 510	spring	1	
539	631 z 505	bearing bracket (to kickstart lever)	1	
540	184 z 503	sleeve	1	
541	671 z 301	kickstart lever (engages ratchets)	1	
542	1564 z 11	screw (to kickstart lever)	1	
—	—	washer 18 DIN 126 k	1	
—	—	split pin 4 x 30 DIN 94 k	1	
543	1441 z 254	clamp, upper part (to center stand)	2	
—	—	screw, countersunk head, M 8 x 15 DIN 63 k (to fasten clamp to center stand)	2	
544	1424 z 6	bearing bushing	4	
—	—	hex. screw M 8 x 30 DIN 931 k (to fasten clamp to center stand)	2	
—	—	spring washer A 8 DIN 127 k	2	
545	321 z 294	spring	2	

Illustration 19, Group R: a) Frame, Swinging Arm

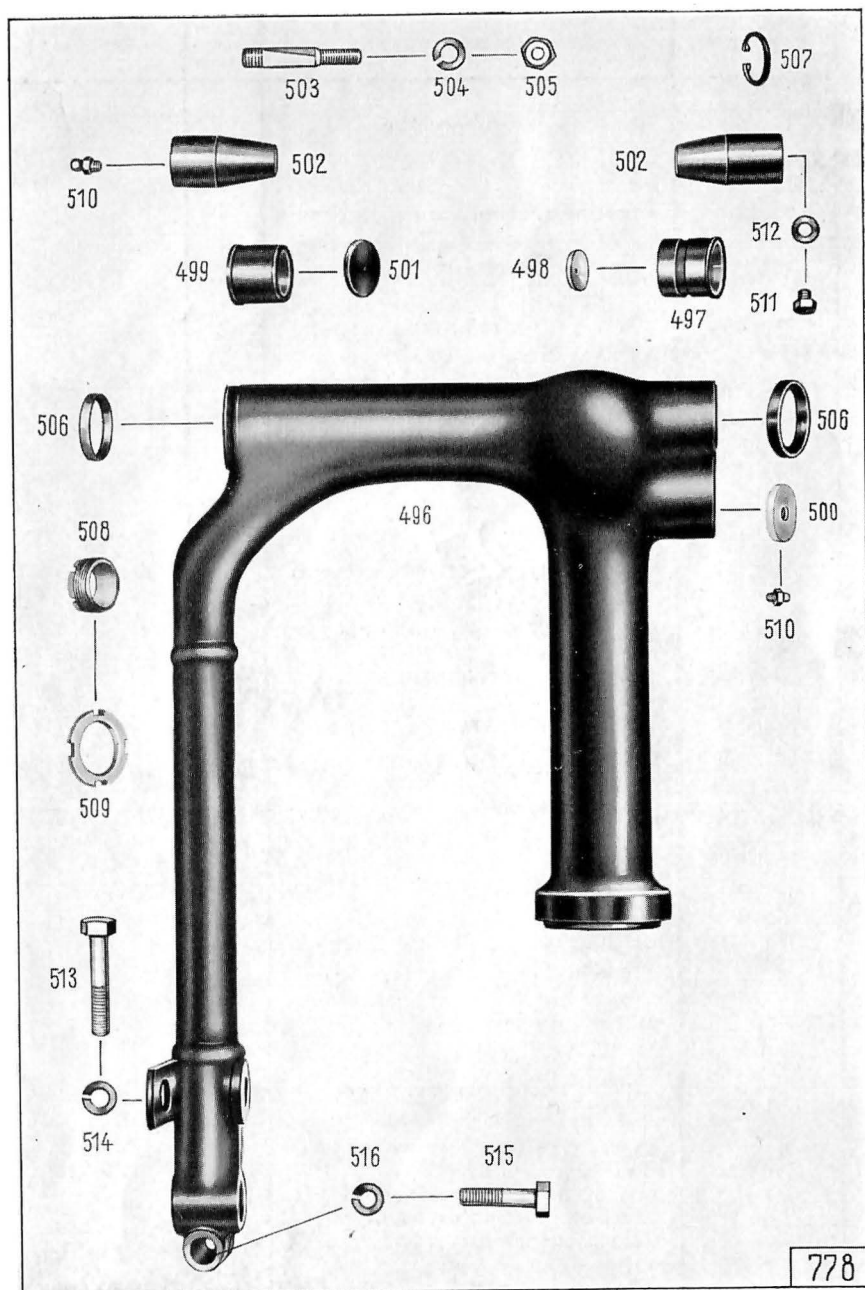

Illustration 19, Group R: a) Frame, Swinging Arm

Key No.	Spare Part No.	Description	No. of Pieces	Remarks
Swinging Arm				
496	710 z 209	swinging arm, complete	1	
497	184 z 533	bushing (to swinging arm, right-hand side)	1	
498	1281 z 393	lock washer	1	
499	184 z 532	bushing (to swinging arm, left-hand side)	1	
500	231 z 207	cover (to swinging arm, right-hand side)	1	
501	231 z 208	cover (to swinging arm, left-hand side)	1	
502	121 z 1126	bearing pin	2	
503	121 z 1127	cotter pin (to fasten bearing pin to frame)	2	
504	—	spring washer A 8 DIN 127 k	2	
505	—	hex. nut M 8 DIN 934 k	2	
506	1236 z 53	packing washer	2	
507	—	circlip 25 x 1,2 DIN 472 k	1	
508	1241 z 362	threaded ring	1	
509	1011 z 206	splined nut	1	
510	1080 z 1	grease nipple	2	
511	—	hex. screw M 6 x 6 DIN 933 k (on bearing pin, right-hand side)	1	
512	—	washer 6,4 DIN 125 k	1	
513	—	hex. screw M 10 x 1 x 50 DIN 960 k (to fasten spring unit to swinging arm)	1	
514	—	spring washer A 10 DIN 127 k	1	
515	—	hex. screw M 10 x 40 DIN 931 k (to fasten rear wheel axle)	1	
516	—	spring washer A 10 DIN 127 k	1	

Illustration 19a, Group R: a) Frame, Spring Unit

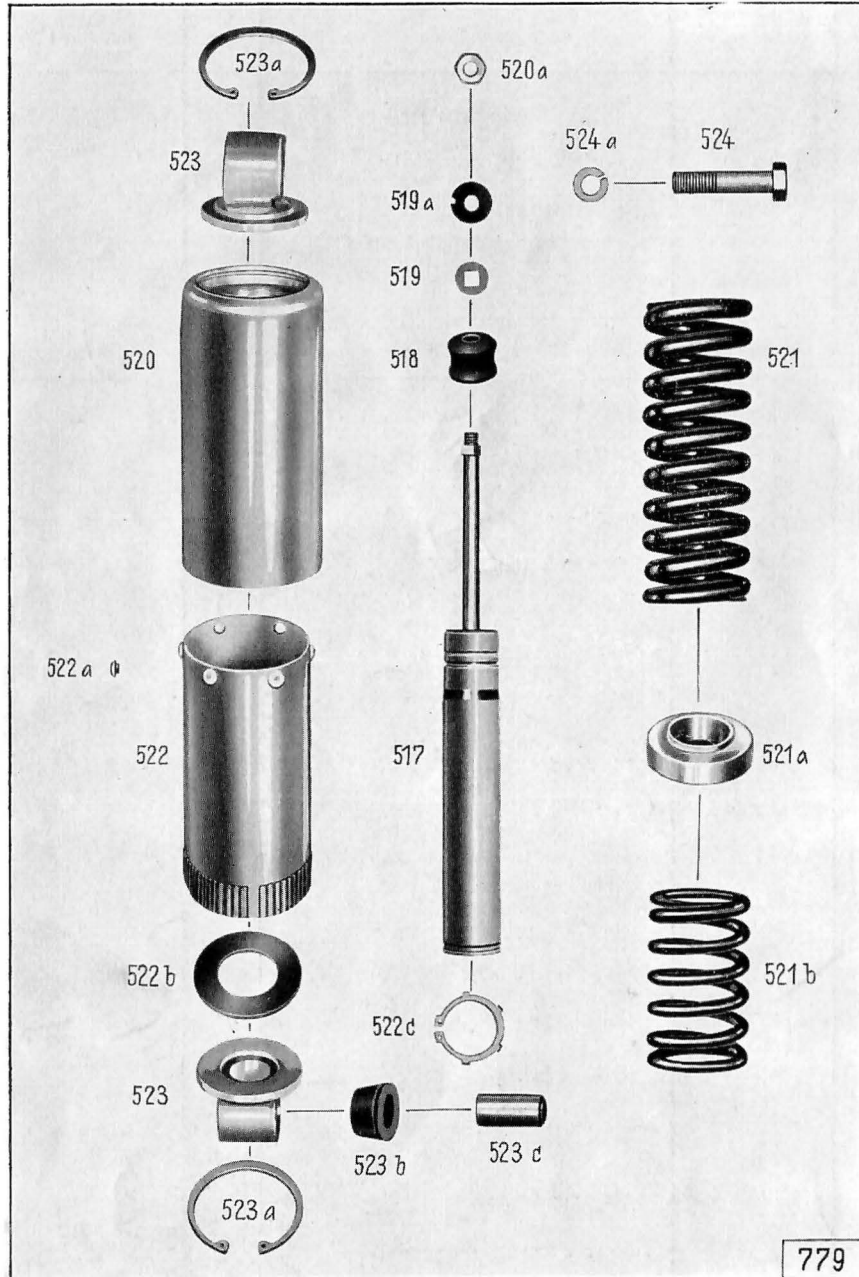

Illustration 19a, Group R: a) Frame, Spring Unit

Key No.	Spare Part No.	Description	No. of Pieces	Remarks
Spring Unit (also called "Spring Leg")				
—	6350 z 106	spring unit with hydraulic shock absorber, complete	2	
517	6350 z 105	shock absorber	2	
518	616 z 243	rubber damper	2	
519	1301 z 667	washer	2	
519a	—	safety washer 8,4 DIN 432 k	2	
520	173 z 108	protective sleeve, outer	2	
520a	—	hex. nut M 8 x 1 DIN 936 k	2	
521	321 z 563	pressure spring, long	2	
521a	1243 z 9	spacer ring	2	
521b	321 z 562	pressure spring, short	2	
522	170 z 206	protective sleeve, inner	2	
522a	1127 z 5	distance piece (mushroom-shaped)	12	
522b	1241 z 366	spacer ring	2	
522c	1251 k 263	circlip-K (to fasten shock absorber within inner protective sleeve)	2	
523	553 z 109	bar head (upper and lower)	4	
523a	—	circlip 55 x 2 DIN 472 k (to fasten bar head within protective sleeve at top and at bottom)	4	
523b	176 z 33	rubber bushing (within bar head)	8	
523c	1331 z 785	distance tube (within bar head)	4	
524	—	hex. screw M 10 x 1 x 50 DIN 960 k (to fasten spring unit to frame)	2	
524a	—	spring washer A 10 DIN 127 k	2	

Illustration 20, Group R: b) Foot Rests and Dual Seat

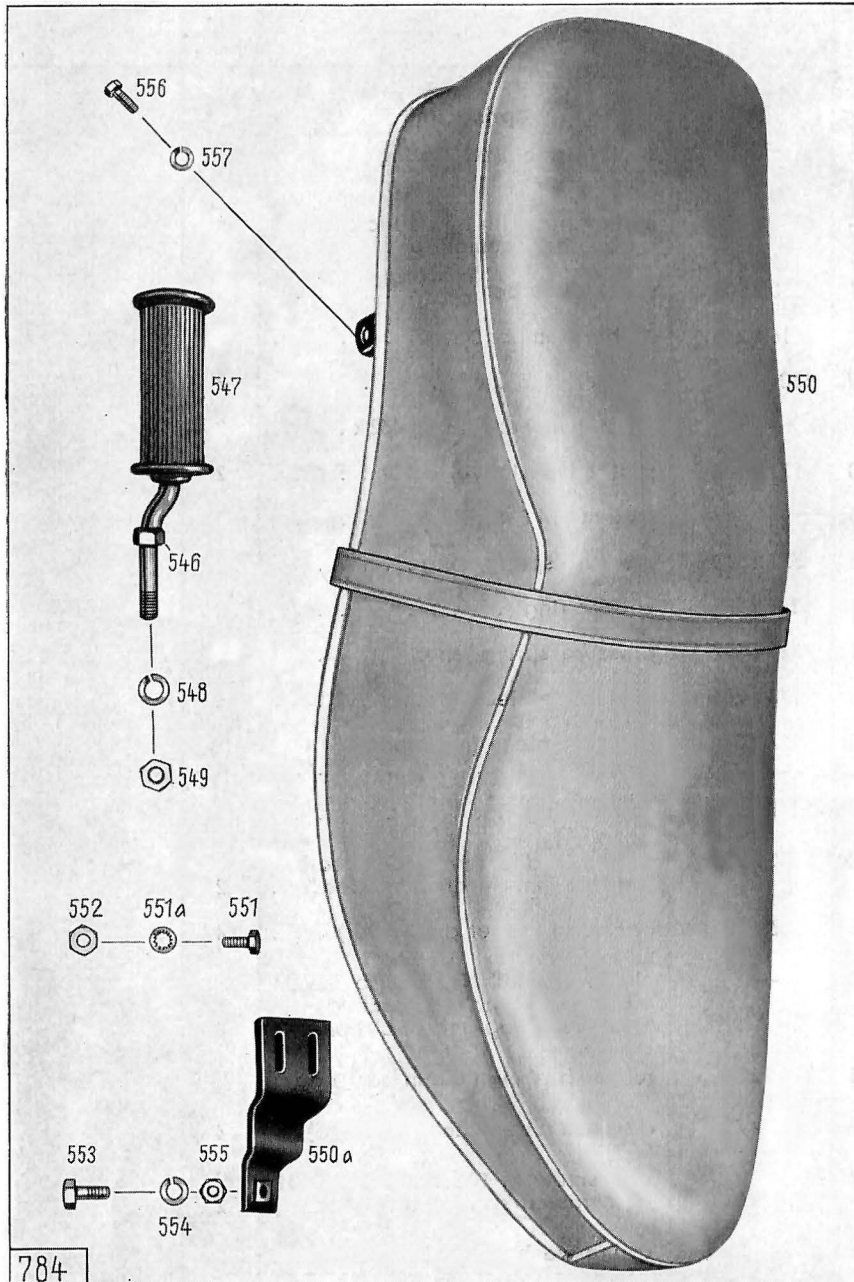

Illustration 20, Group R: b) Foot Rests and Dual Seat

Key No	Spare Part No.	Description	No. of Pieces	Remarks
Foot Rests				
546	631 z 508	foot rest arm	2	
547	616 z 06	foot rest rubber	2	
548	—	spring washer A 12 DIN 127 k . . .	2	
549	—	hex. nut M 12 x 1,5 DIN 934 k	2	
—	—	shake-proof (toothed) washer J 12,5 DIN 6797 k	2	
—	630 k 214	pillion foot rest	2	
—	616 z 01	rubber sleeve	2	
Dual Seat				
550	6330 z 49	dual seat	1	
550a	2361 k 18-8	bracket (for dual seat)	1	
551	—	hex. screw M 8 x 20 DIN 933 k (to fasten bracket to dual seat) . . .	2	
—	—	washer 8,4 DIN 125 k	2	
551a	—	spring washer A 8 DIN 127 k	2	
552	—	hex. nut M 8 DIN 934 k	2	
553	—	hex. screw M 8 x 15 DIN 933 k (to fasten bracket for dual seat to frame)	1	
554	—	spring washer A 8 DIN 127 k	1	
555	—	hex. nut M 8 DIN 934 k	1	
556	—	hex. screw M 8 x 12 DIN 933 k (to fasten dual seat to rear part of frame)	2	
557	—	spring washer A 8 DIN 127 k	2	

Illustration 21, Group R: c) Fenders, Front Wheel Fender, Front Wheel Stand

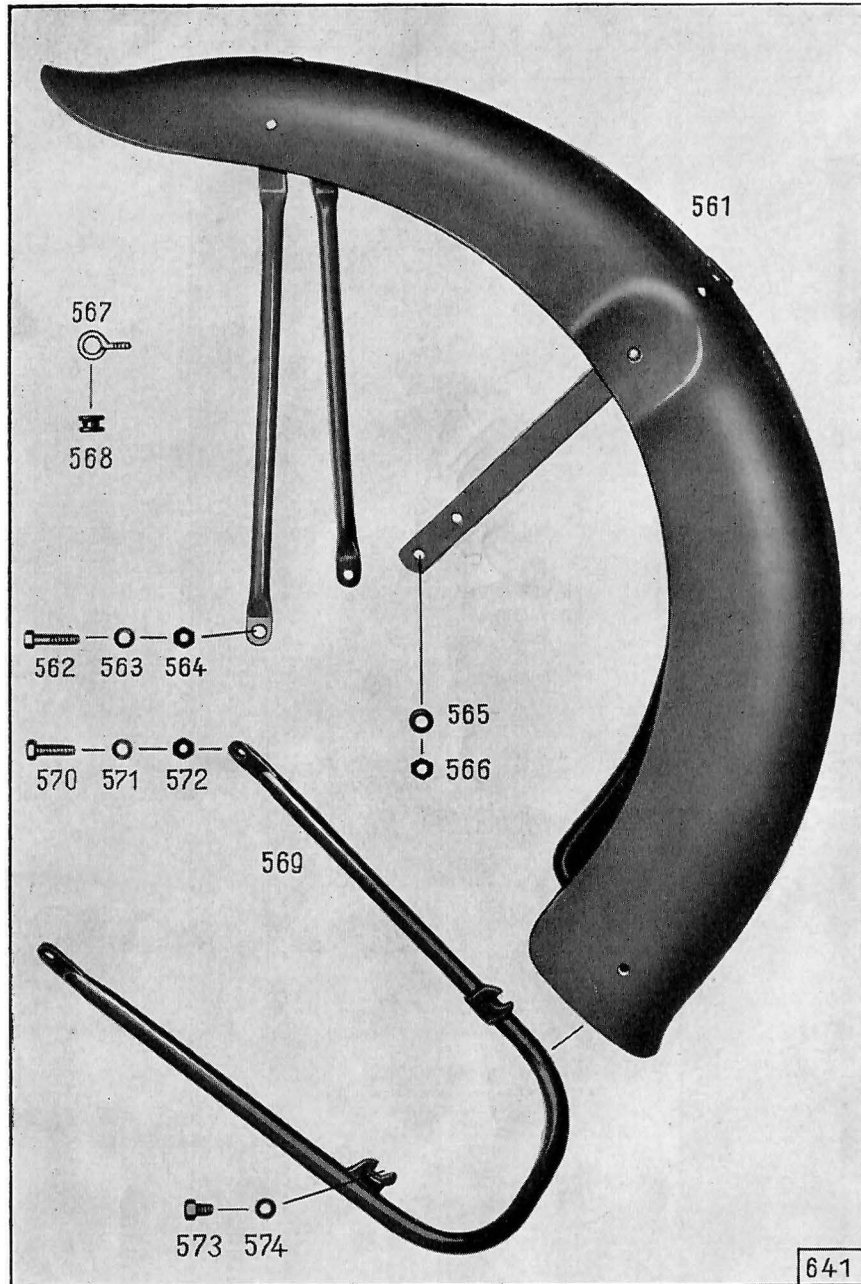

Illustration 21, Group R: c) Fenders, Front Wheel Fender, Front Wheel Stand

Key No.	Spare Part No.	Description	No. of Pieces	Remarks
Front Wheel Fender				
561	6370 z 101	front wheel fender	1	
562	—	hex. screw M 8 x 28 DIN 931 crp (to fasten fender to fork leg) . . .	2	
563	—	spring washer A 8 DIN 137 k.	2	
564	—	hex. nut M 8 DIN 934 crp	2	
565	—	spring washer B 6 DIN 137 k.	4	
566	—	hex. nut M 6 DIN 934 crp	4	
567	1541 z 303	ring screw	1	
—	—	hex. nut M 4 DIN 934 k.	1	
—	—	shake-proof (toothed) washer A 4,3 DIN 6797 k.	1	
—	—	hex. nut M 4 DIN 934 crp	1	
568	1806 z 07	rubber grommet	1	
Front Wheel Stand				
569	1750 z 205	front wheel stand	1	
570	—	hex. screw M 8 x 25 DIN 933 crp (to fasten front wheel stand to fork)	2	
571	—	spring washer A 8 DIN 137 k.	2	
572	—	hex. nut M 8 DIN 934 crp	2	
573	—	hex. screw M 8 x 12 DIN 933 crp (to fasten front wheel stand to fender)	2	
574	—	washer 8,4 DIN 125 k	2	

Illustration 22, Group R: c) Fenders, Rear Wheel Fender, Safety Bars

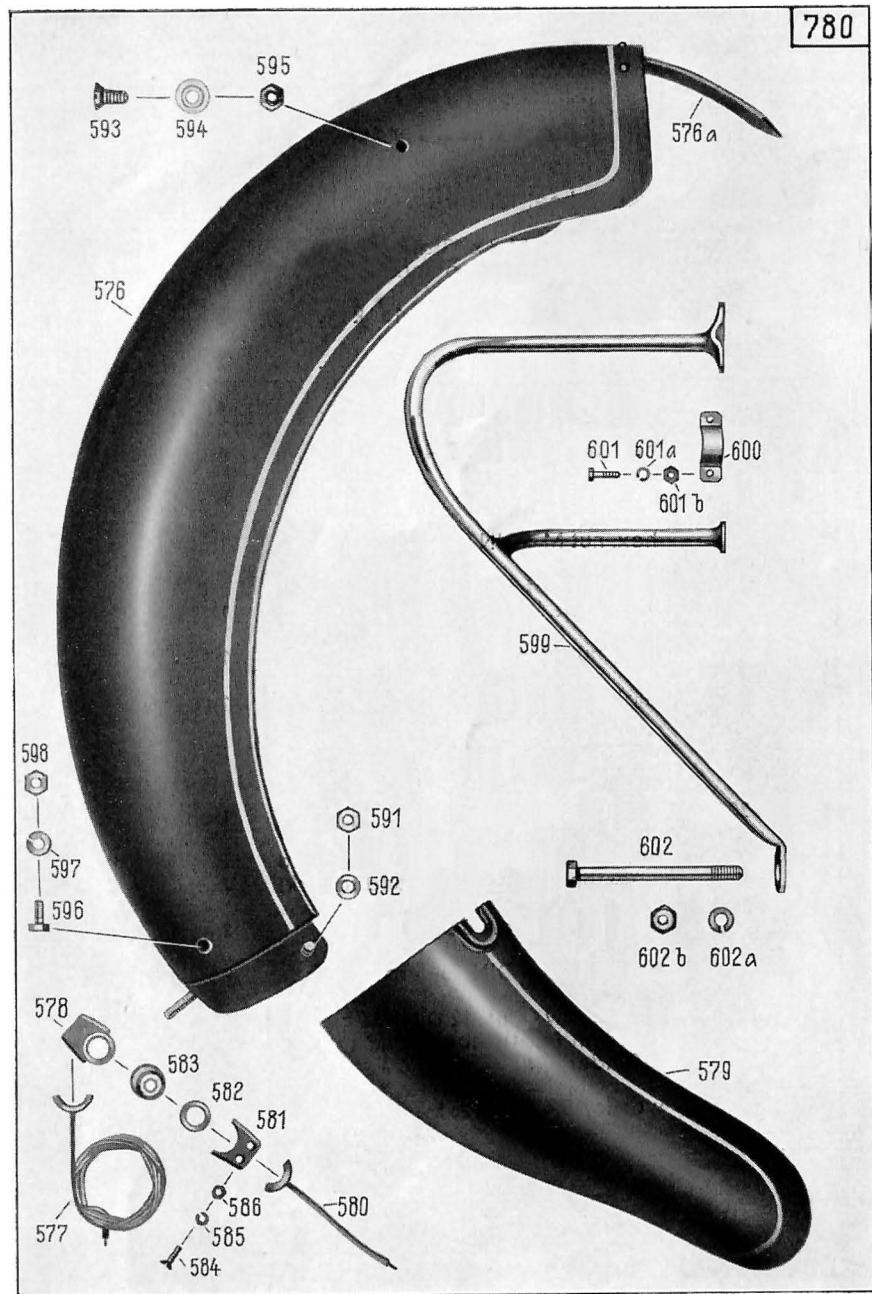

Illustration 22, Group R: c) Fenders, Rear Wheel Fender, Safety Bars

Key No.	Spare Part No.	Description	No. of Pieces	Remarks
Rear Wheel Fender				
576	6370 z 175-0	rear wheel fender, front part . . .	1	
576a	616 z 257	wing	1	
	— —	rivet, hollow A 4 x 11 x 12 DIN 7331	3	
577	770 z 5	half of contact (to fender, front part)	1	
578	777 z 201	insulating piece	1	
579	6370 z 94	rear wheel fender, rear part . . .	1	
580	770 z 6	half of contact (to fender, rear part)	1	
581	777 z 11	insulating piece	1	
582	1304 z 34	contact washer	1	
583	177 z 102	insulating bushing	1	
584	—	screw, countersunk raised head, M 4 x 15 DIN 88 k (to fasten half of contact to rear wheel fender, rear part)	2	
585	—	spring washer A 4 DIN 127 k . . .	2	
586	—	hex. nut M 4 DIN 934 k	2	
591	—	hex. nut M 8 DIN 934 crp (to fasten rear part of fender to front part)	3	
592	—	washer 8,4 DIN 125 k	3	
593	1541 z 165	screw, countersunk head (to fasten rear wheel fender to frame) . .	2	
594	1301 z 412	washer	2	
595	—	hex. nut M 10 DIN 934 crp	2	
596	—	hex. screw M 8 x 15 DIN 933 crp (to fasten front part of fender to yoke of frame)	2	
597	—	spring washer A 8 DIN 127 k . . .	2	
598	—	hex. nut M 8 DIN 934 k	2	

Illustration 22, Group R: c) Fenders, Rear Wheel Fender, Safety Bars

Key No.	Spare Part No.	Description	No. of Pieces	Remarks
Safety Bars				
—	1340 z 52	safety bar, left-hand	1	
599	1340 z 57	safety bar, right hand	1	
600	1441 z 151	clamp	4	
601	—	hex. screw M 6 x 25 DIN 931 crp (to fasten safety bars to lower part of frame)	8	
601a	—	spring washer A 6 DIN 127 k	8	
601b	—	hex. nut M 6 DIN 934 k	8	
602	—	hex. screw M 16 x 1,5 x 150 DIN 960 crp (to fasten safety bars to upper part of frame)	1	
602a	—	spring washer A 16 DIN 127 k	1	
602b	—	hex. nut M 16 x 1,5 DIN 936 crp	1	

Illustration 23, Group R: d) Fuel Tank and Fuel Pipes

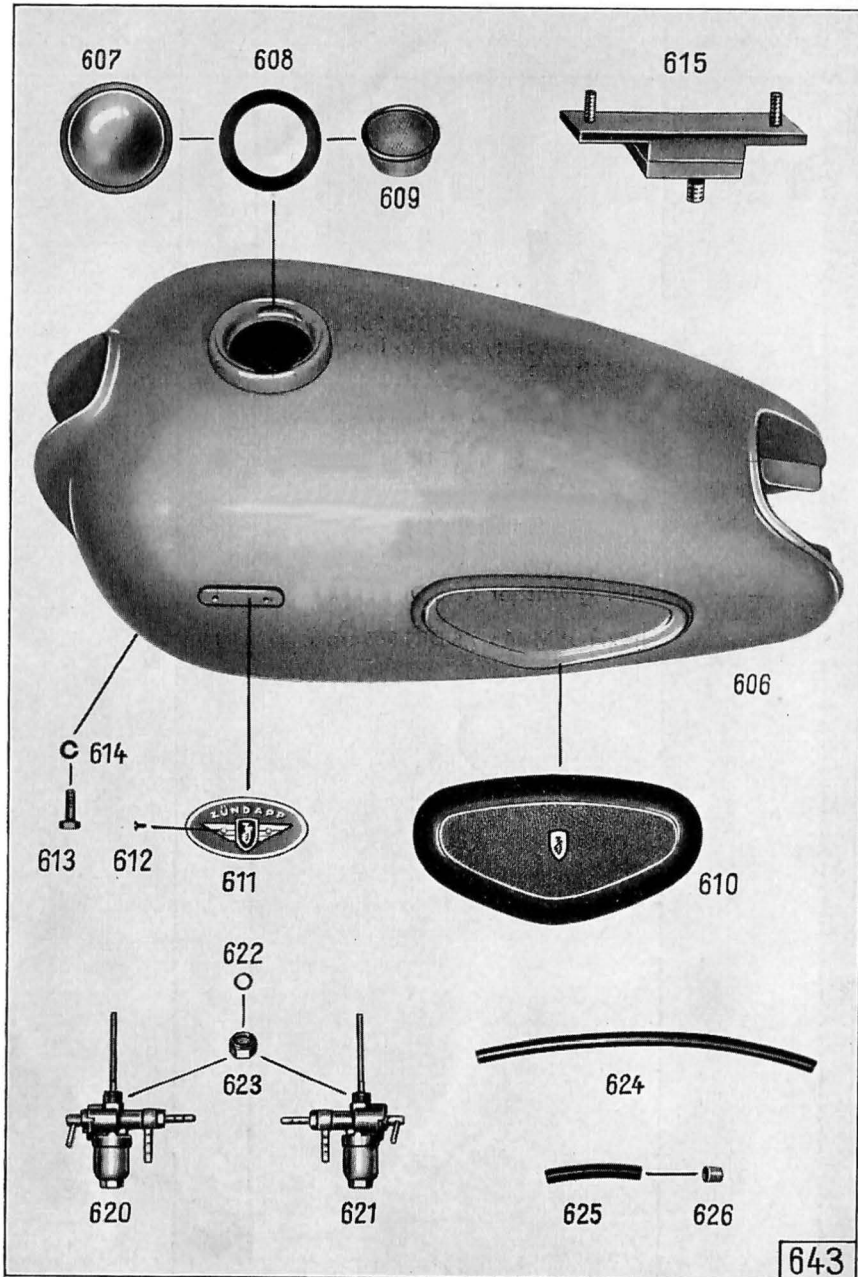

Illustration 23, Group R: d) Fuel Tank and Fuel Pipes

Key No.	Spare Part No.	Description	No. of Pieces	Remarks
Fuel Tank				
606	6230 z 132	fuel tank	1	
607	1850 z 27	filler cap	1	
608	2456 k 4	gasket (to filler cap)	1	
609	2210 z 30	fuel strainer	1	
610	616 z 82	knee pad	2	
611	1483 z 32	emblem, left-hand	1	
—	1483 z 33	emblem, right-hand	1	
612	—	screw, countersunk raised head, AM 3 x 6 DIN 91 k (to emblem)	4	
613	—	hex. screw M 8 x 45 DIN 931 k (to fasten fuel tank to front part of frame)	2	
614	—	spring washer A 8 DIN 127 k.	2	
—	616 z 253	rubber piece	2	
—	1331 z 861	distance tube	2	
—	1181 z 411	bracket	2	
—	1301 z 035	washer	as required	
615	610 z 2	rubber damper	1	
—	—	spring washer A 8 DIN 127 k.	1	
—	—	hex. nut M 8 DIN 934 k	1	
—	—	screw, countersunk head, M 6 x 15 DIN 63	2	
—	—	washer 6,4 DIN 125	2	
—	—	hex. nut M 6 DIN 934	2	
—	616 z 92	rubber sleeve	4	
—	1391 z 168	cable band	4	

Illustration 23, Group R: d) Fuel Tank and Fuel Pipes

Key No.	Spare Part No.	Description	No. of Pieces	Remarks
Fuel Tap				
620	6010 z 39	fuel tap, left-hand	1	
621	6010 z 40	fuel tap, right hand	1	
622	—	packing washer A 10 x 14 DIN 7603 .	2	
623	1001 z 55	nut	2	
Fuel Pipes				
624	—	fuel hose C 8 x 12 x 260 DIN 73 379	2	
625	—	fuel hose C 8 x 12 x 72 DIN 73 379 .	1	
626	—	metal sleeve (for hose) D 13 DIN 73 379	6	

Illustration 24, Group R: e) Exhaust Set

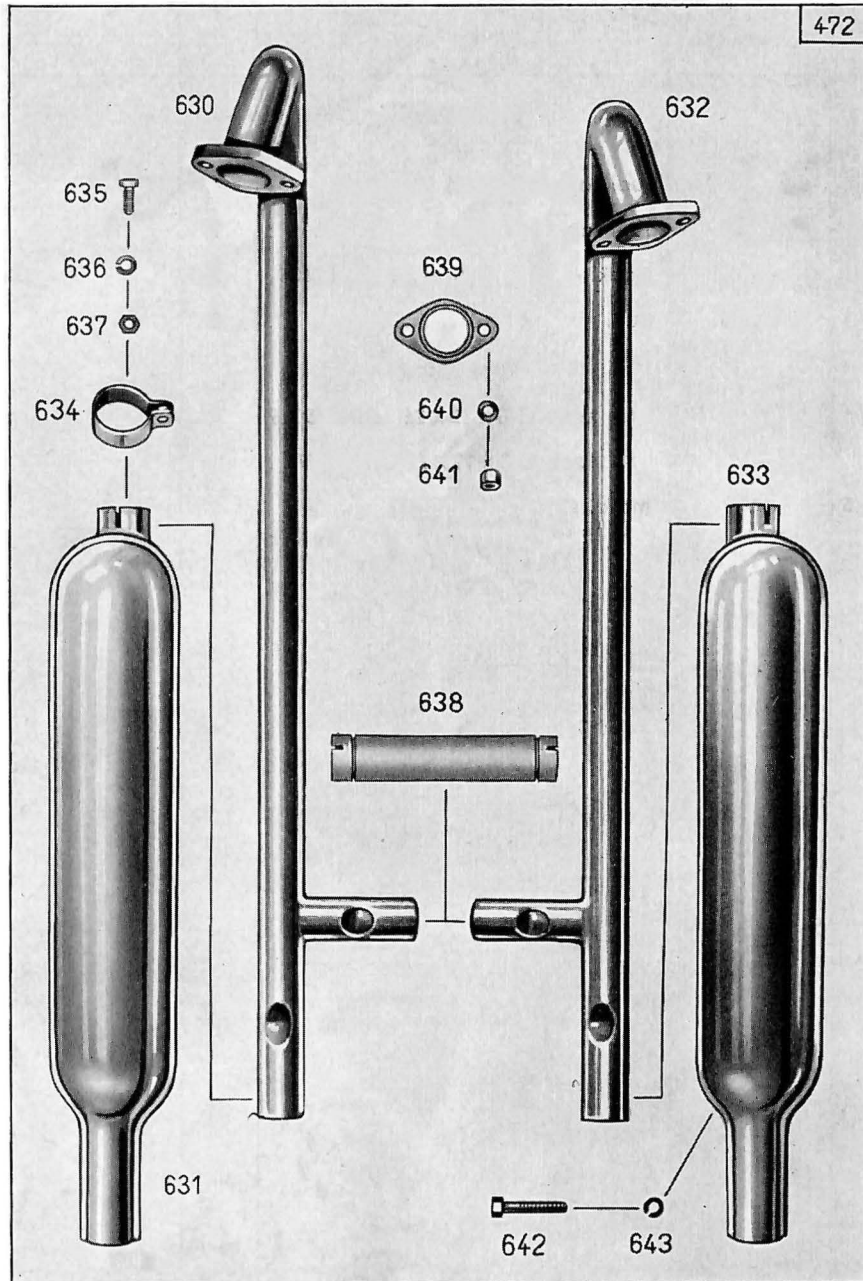

Illustration 24, Group R: e) Exhaust Set

Key No.	Spare Part No.	Description	No. of Pieces	Remarks
Exhaust Set				
630	1350 z 30	exhaust pipe, left-hand	1	
631	6030 z 328	silencer, left-hand	1	
632	1350 z 31	exhaust pipe, right-hand	1	
633	6030 z 329	silencer, right-hand	1	
634	1441 z 257	clamp (to fasten silencers to exhaust pipes)	2	
635	—	hex. screw M 8 x 18 DIN 933 crp (to clamp)	2	
636	—	spring washer A 8 DIN 127 k	2	
637	—	hex. nut M 8 DIN 934 k	2	
638	1351 z 62	connecting pipe (between exhaust pipes)	1	
639	469 z 6	gasket (between exhaust pipe and cylinder head)	2	
640	—	washer 8,4 DIN 433 k	4	
641	—	cap nut M 8 DIN 917 crp	4	
642	—	hex. screw M 8 x 15 DIN 933 k (to fasten silencers to frame)	2	
643	—	spring washer A 8 DIN 127	2	

Illustration 25, Group R: f) Front Fork (Assembly)

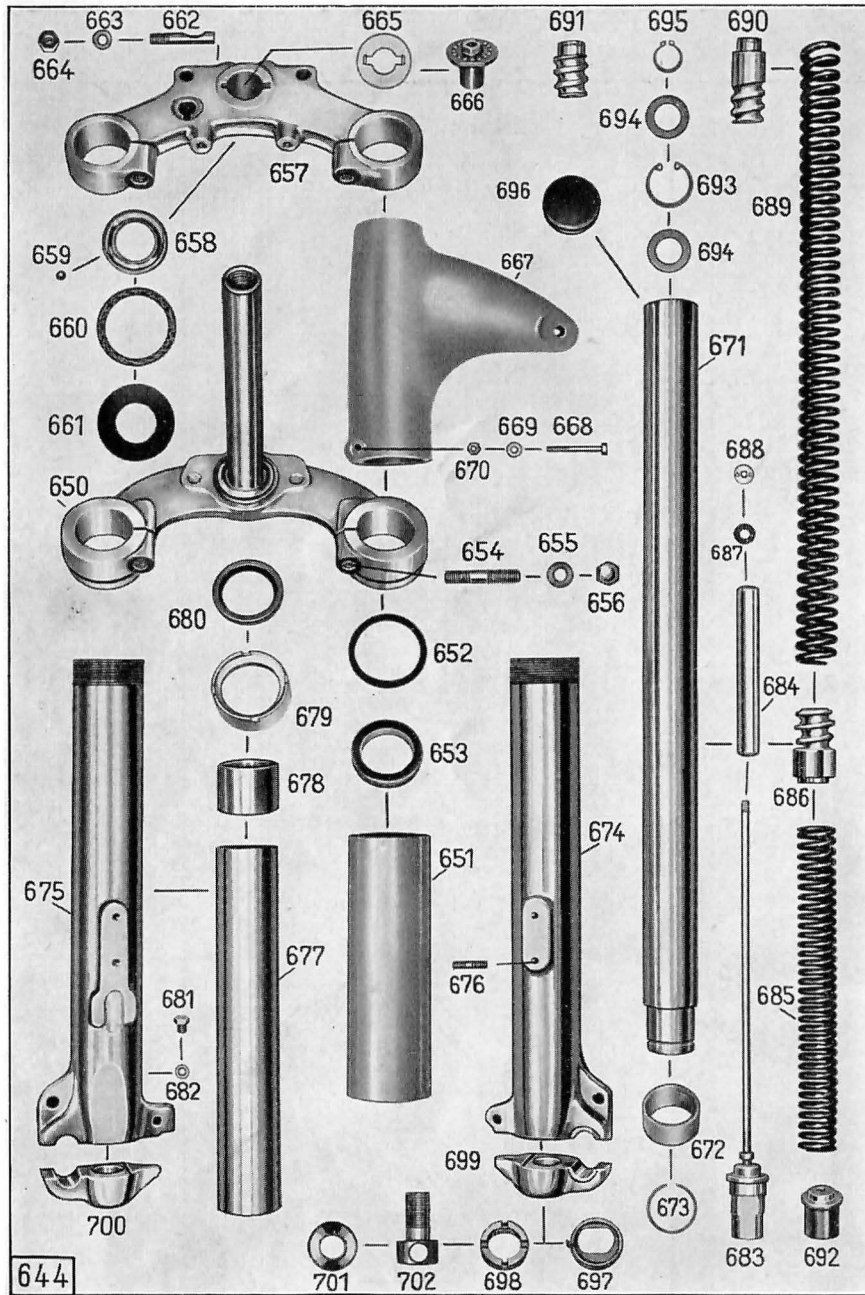

Illustration 25, Group R: f) Front Fork Assembly, Front Fork Suspension

Key No.	Spare Part No.	Description	No. of Pieces	Remarks
Front Fork				
—	6810 k 232	telescopic front fork (please quote whether for solo or side-car work, when ordering)	1	
Front Fork Suspension				
650	1200 z 52	fork connecting member, lower	1	
658	1871 z 170	fork race	1	
659	—	ball 6,35 mm III DIN 5401	19	
651	1331 z 604	protective sleeve	2	
652	1236 z 217	packing washer (to protective sleeve)	2	
653	1236 z 219	rubber ring (to protective sleeve)	2	
654	—	stud AM 10 x 35 DIN 835 k (to fasten fork tubes to lower fork connecting member)	2	
655	—	spring washer A 10 DIN 137 k	2	
656	—	cap nut M 10 DIN 917 crp	2	
657	1200 z 51	fork connecting member, upper	1	
658	1871 z 170	fork race	1	
659	—	ball 6,35mm III DIN 5401	19	
660	1236 z 218	packing washer (to ball race)	3	
661	1281 z 238	covering washer	1	
662	121 z 519	cotter pin (to fasten upper fork connecting member to fork shank)	2	
663	—	spring washer A 8 DIN 137 k	2	
664	—	hex. nut M 8 DIN 934 crp	2	
654	—	stud AM 10 x 35 DIN 835 k (to fasten fork tubes to upper fork connecting member)	2	

Illustration 25, Group R: f) Front Fork, Front Fork Suspension, Fork Legs

Key No.	Spare Part No.	Description	No. of Pieces	Remarks
655	—	spring washer A 10 DIN 137 k	2	
656	—	cap nut M 10 DIN 917 crp	2	
665	1291 z 62	safety disc	1	
666	1541 z 148	screw	1	
667	633 z 9	headlight carrier	2	
668	—	hex. screw M 5 x 40 DIN 931 k (to fasten headlight carrier to fork tube)	2	
669	—	washer 5,3 DIN 125 k	2	
670	—	hex. nut M 5 DIN 934 k	2	
Fork Legs				
671	1331 z 605	fork tube	2	
672	180 z 18	sliding bushing	2	
673	1251 z 173	snap ring (to fasten sliding bushing to fork tube)	2	
674	1203 z 9	fork guide tube, left-hand	1	
675	1203 z 11	fork guide tube, right-hand	1	
676	—	stud AM 6 x 12 DIN 835 k (to fasten mudguard to fork guide tube)	4	
677	1331 z 952	guiding bushing	2	
678	180 z 17	sliding bushing	2	
679	1011 z 68	circular nut	2	
680	6860 z 82	sealing ring (within circular nut)	2	
681	—	hex. screw M 6 x 8 DIN 933 crp (for oil draining)	2	
682	—	packing washer A 6 x 10 DIN 7603 Alu	2	
683	630 z 201	spring carrier (at bottom)	2	
684	203 z 10	guiding piece	2	

Illustration 25, Group R: f) Front Fork, Front Fork Suspension, Fork Legs

Key No.	Spare Part No.	Description	No. of Pieces	Remarks
685	321 z 585	pressure spring, short	2	
686	633 z 12	spring carrier (at center)	2	
687	1236 z 208	rubber ring	2	
688	—	two-way nut M 6 DIN 547	2	
689	321 z 586	pressure spring, long	2	
690	—	not mounted with model KS 601 El.	—	
691	633 z 13	spring carrier (at top)	2	
692	—	not mounted with model KS 601 El.	—	
693	—	circlip 32 x 1,5 DIN 472 (to fasten spring element into fork tube, at top)	2	
694	1301 z 408	washer	4	
695	—	circlip 19 x 1,2 DIN 471 (to fasten spring element to circlip, at top)	2	
696	616 z 204	plug (to fork tube, at top)	2	
697	781 z 268	safety cup	2	
698	1011 z 67	round nut (to fasten spring element to fork guide tube, at bottom)	2	
699	233 z 91	cap, left-hand (to fork guide tube, at bottom)	1	
700	233 z 92	cap, right-hand (to fork guide tube, at bottom)	1	
701	—	spring washer B 18 DIN 137 k	2	
702	1541 z 301	lock screw (to fasten cap to fork guide tube, at bottom)	2	

Illustration 26, Group R: f) Front Fork, Shock Absorber, Steering Damper

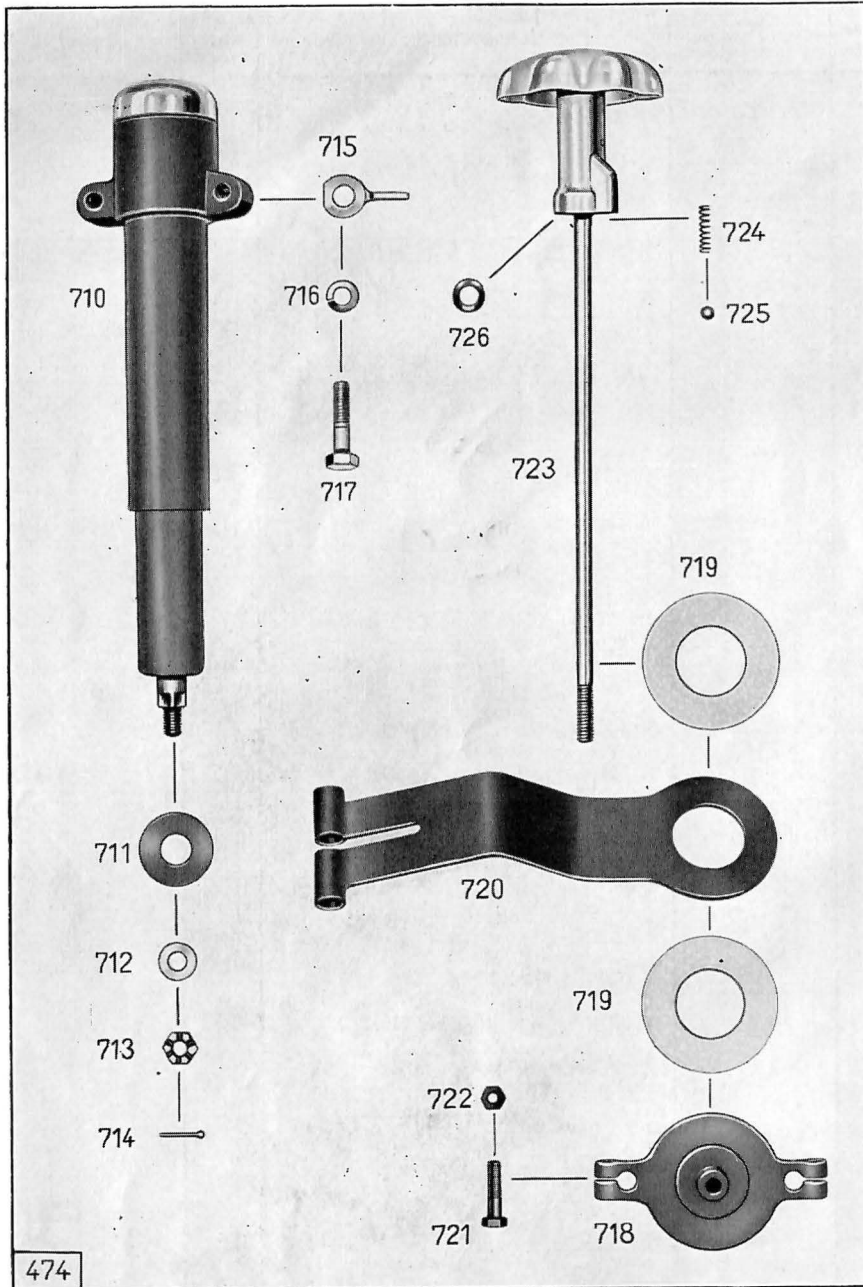

Illustration 26, Group R: f) Front Fork, Shock Absorber, Steering Damper

Key No.	Spare Part No.	Description	No. of Pieces	Remarks
Shock Absorber				
710	6350 z 27	shock absorber	1	
711	2376 k 1	rubber ring	1	
—	2371 k 1	lock cap	1	
712	—	washer 8,4 DIN 125	1	
713	—	castle nut M 8 DIN 935 (to fasten shock absorber to front wheel fender)	1	
714	—	split pin 1,6 x 15 DIN 94	1	
715	631 z 289	cable support	2	
—	—	washer 8,4 DIN 433 k	2	
716	—	spring washer B 8 DIN 137 k	2	
717	—	hex. screw M 8 x 32 DIN 931 crp (to fasten shock absorber to upper fork connecting member)	2	
Steering Damper				
718	631 z 284	spanner plate	1	
719	1289 z 17	damper washer	2	
720	630 z 404	bracket	1	
721	—	hex. screw M 6 x 22 DIN 931 (to fasten spanner plate to lower fork connecting member)	2	
722	—	hex. nut M 6 DIN 934 k	2	
723	590 z 44	star knob (steering damper adjusting rod with handle), complete	1	
724	321 z 296	pressure spring	1	
725	—	ball 5 mm III DIN 5401	1	
726	—	spring washer B 8 DIN 137 k (between fork shank and star knob)	2	
—	—	split pin 2 x 18 DIN 94 k	1	

Illustration 27, Group R: g) Handlebar and Handlevers with Cables

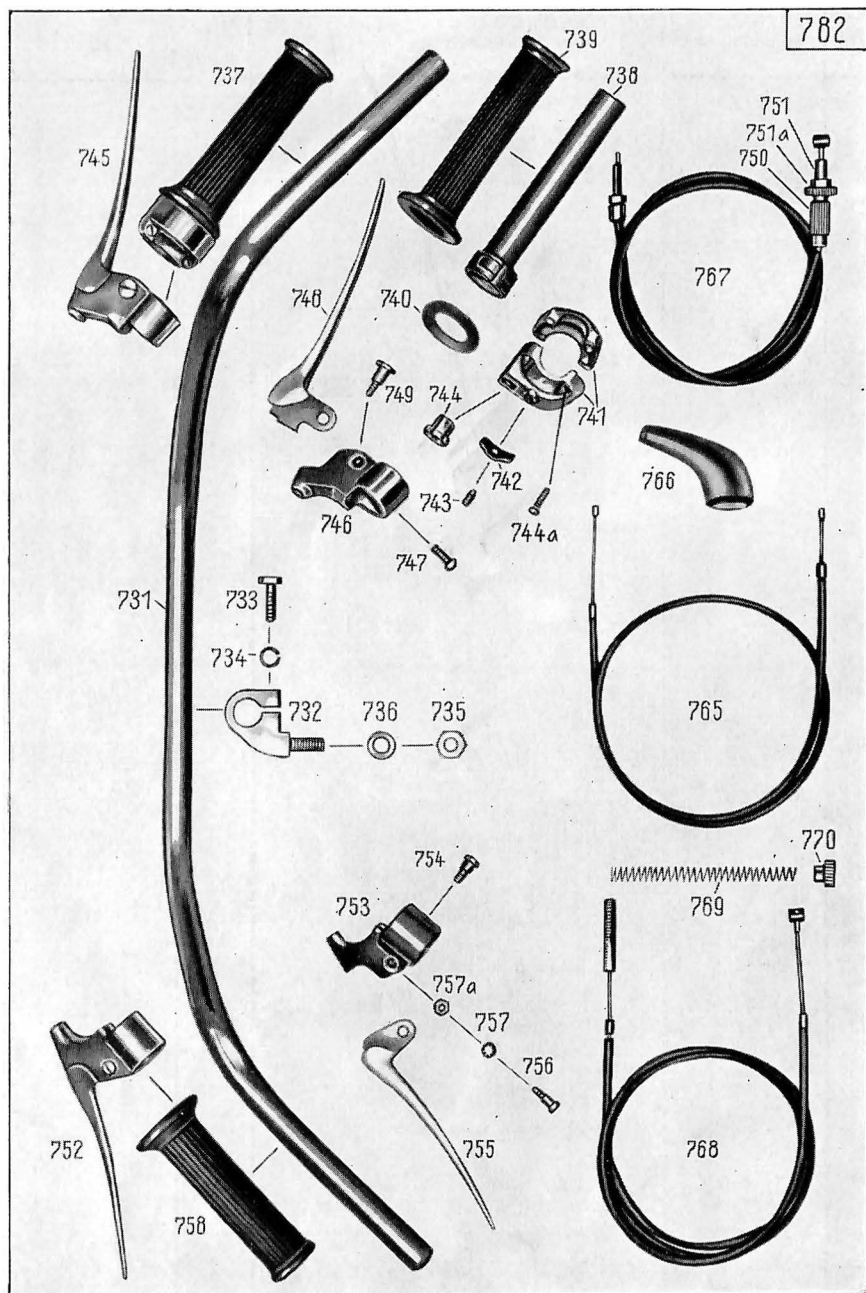

Illustration 27, Group R: g) Handlebar and Handlevers with Cables

Key No.	Spare Part No.	Description	No. of Pieces	Remarks
Handlebar				
731	1370 z 251	handlebar	1	
732	821 z 8	handlebar clamp	2	
733	—	hex. screw M 8 x 22 DIN 931 crp (to fasten handlebar within handlebar clamp)	2	
734	—	spring washer A 8 DIN 127 k	2	
735	—	hex. nut M 10 x 1 DIN 934 crp (to fasten handlebar clamp to upper fork connecting member)	2	
736	—	spring washer B 10 DIN 137 k	2	
Hand Levers				
737	170 z 202	throttle twist grip, complete	1	colour of rubber = black
738	2250 k 6	grip tube with segment ring	1	
739	2256 k 6	rubber sleeve	1	colour of rubber = black
740	2251 k 10	washer	1	
741	2250 k 5	housing (upper and lower part)	1	
742	2251 k 13	brake spring	1	
743	2251 k 14	regulating screw	1	
744	2251 k 11	cable support	1	
744a	2251 k 12	screw, fillister head	2	
745	670 z 210	brake lever with cable adjustment	1	
746	2263 k 22	bracket	1	

Illustration 27, Group R: g) Handlebar and Hand levers with Cables

Key No.	Spare Part No.	Description	No. of Pieces	Remarks
747	2261 k 4	screw, fillister head	1	
748	2263 k 23	brake lever	1	
749	2261 k 5	lever screw	1	
—	—	hex. nut M 6 DIN 934 k	1	
750	2263 k 24	adjusting nut	1	
751	2261 k 24	threaded pin	1	
751a	2263 k 25	knurled edge nut	1	
—	2261 k 25	hex. nut	1	
752	670 z 223	clutch lever, complete	1	
753	2263 k 13	bracket to clutch lever	1	
754	2261 k 4	screw, fillister head (to bracket)	1	
755	2263 k 26	clutch lever	1	
756	2261 k 5	lever screw (to clutch lever)	1	
757	—	shake-proof (toothed) washer J 5,3 DIN 6797	1	
757a	—	hex. nut M 6 DIN 934 k	1	
758	616 z 232	grip	1	colour of rubber = black

Illustration 27, Group R: g) Handlebar and Hand levers with Cables

Key No.	Spare Part No.	Description	No. of Pieces	Remarks
		Cables (Bowden Wires)		
765	6290 z 451	cable for carburettor	2	
—	—	nipple C DIN 71 988	2	
—	144 k 28	nipple	2	
—	—	sleeve C 2,5 DIN 71 987	4	
766	786 z 10	protective cap for carburettor	2	
767	6290 k 452	cable for front wheel brake	1	
—	—	nipple B 2,3 DIN 71 988	1	
—	—	nipple seat A DIN 71 988	1	
—	—	sleeve C 3 DIN 71 987	2	
—	144 z 04	cable end	1	
—	1551 z 402	screw	1	
—	—	hex. nut M 6 DIN 934 k	1	
768	6290 z 164	cable for clutch	1	
—	—	nipple B 2,3 DIN 71 988	1	
—	—	nipple seat A DIN 71 988	1	
—	—	sleeve C 3 DIN 71 987	2	
—	1561 z 67	threaded pin	1	
769	321 z 137	spring	1	
770	1021 z 101	knurled edge nut	1	

Illustration 28, Group B: a) Brakes, Handbrake

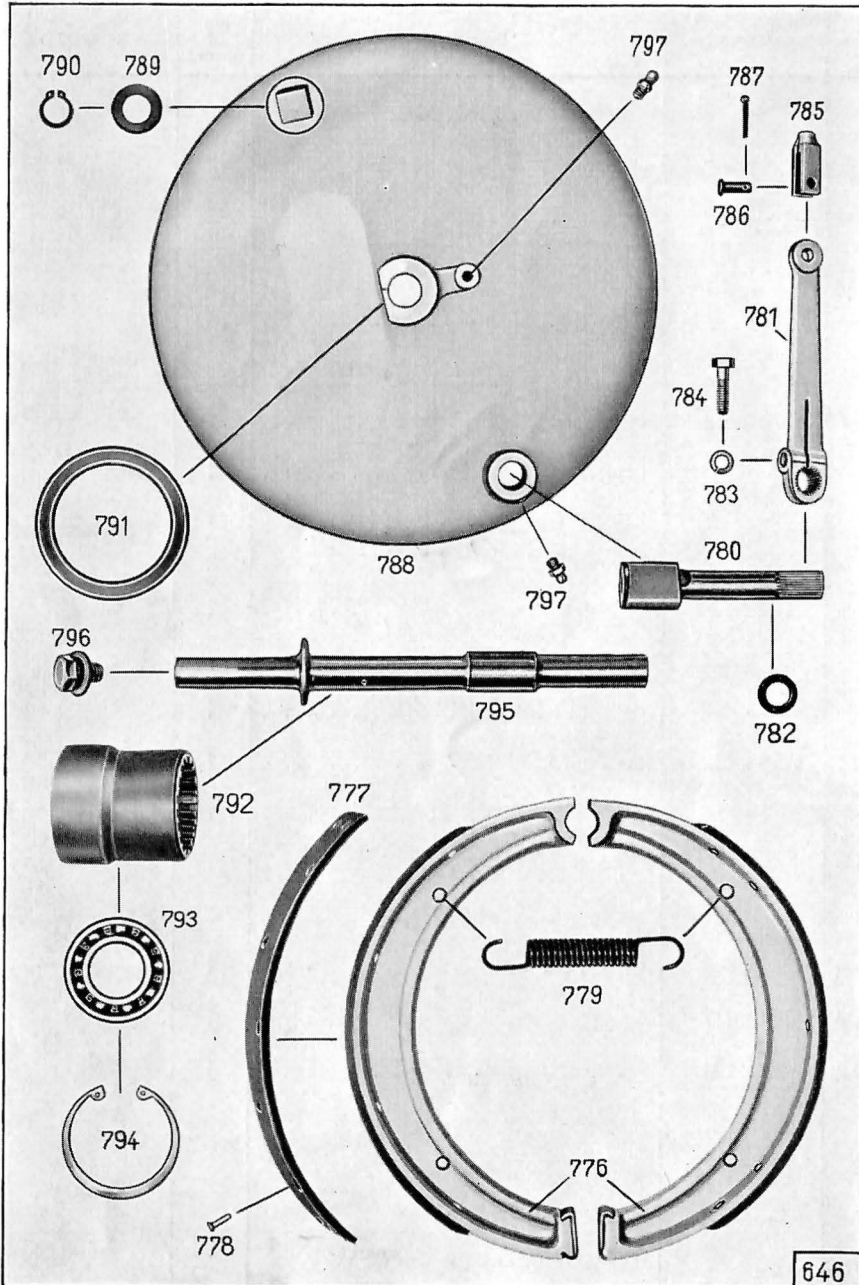
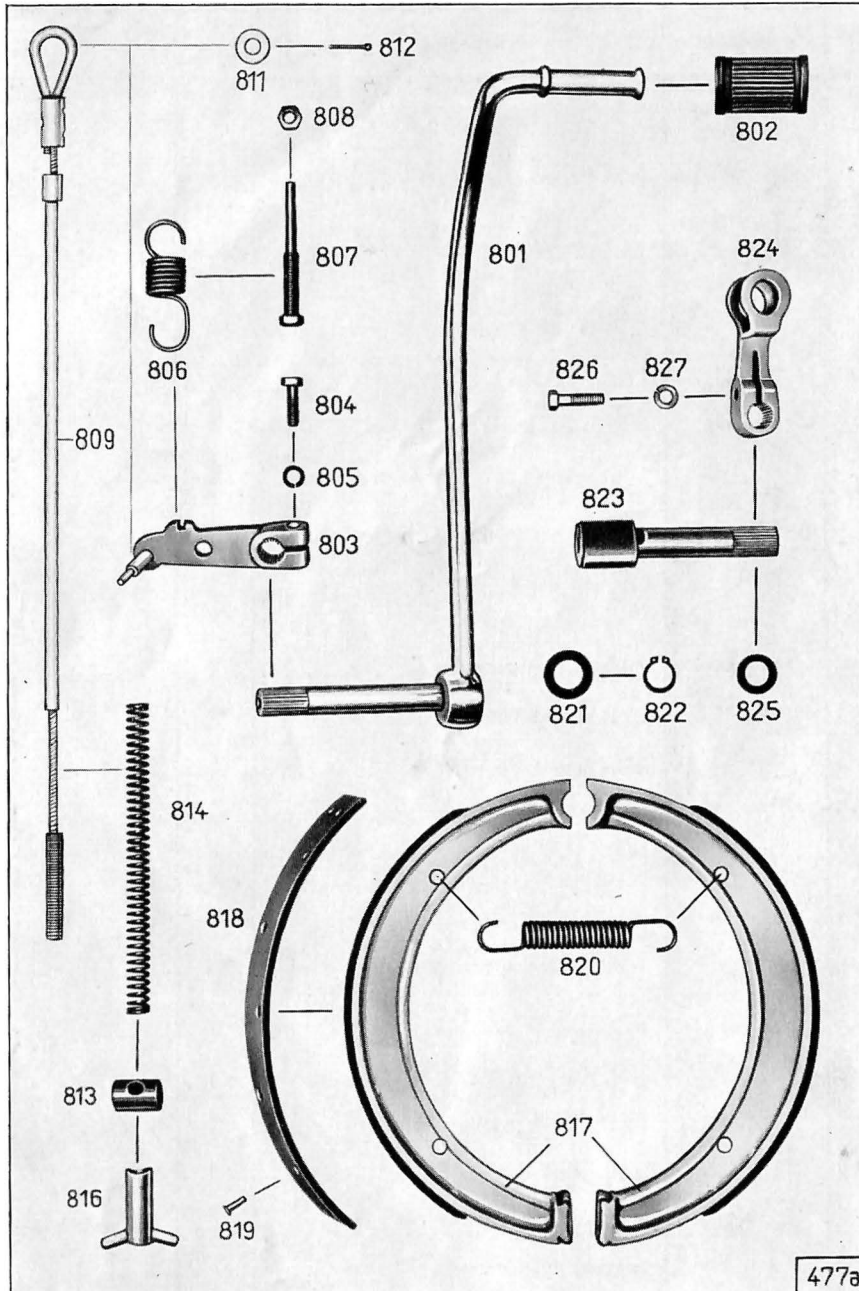

Illustration 28, Group B: a) Brakes, Handbrake

Key No.	Spare Part No.	Description	No. of Pieces	Remarks
Handbrake				
776	20 z 25	brakeshoe with lining	2	
777	49 z 13	brake lining	2	
778	1044 z 11	cylindrical rivet	18	
779	321 z 024	spring (betw. brakeshoes)	2	
780	1100 z 24	brake cam	1	
781	671 z 175	brake lever	1	
782	1236 z 215	rubber ring (betw. brake lever and brake cover)	1	
783	—	spring washer A 6 DIN 127 k	1	
784	—	hex. screw M 6 x 22 DIN 931 crp (to fasten brake lever to brake cam)	1	
785	551 z 101	clip (fork-shaped)	1	
786	131 z 01	bolt (to fasten clip to brake lever)	1	
787	—	split pin 1,5 x 12 DIN 94 k	1	
788	230 z 142	brake cover with supporting bolt	1	
789	1301 z 190	washer (to fasten brakeshoes to brake cover)	1	
790	—	circlip 14 x 1 DIN 471	1	
791	—	radial packing ring B 58 x 75 x 12 DIN 6503	1	
792	960 z 104	connecting member	1	
793	—	ball bearing 6205 Z DIN 625	1	
794	—	circlip 52 x 2 DIN 472	1	
795	121 z 506	front wheel axle	1	
796	1550 z 46	screw with washer	2	
797	—	grease nipple D 6 DIN 71 412	2	

Illustration 29, Group B: a) Brakes, Footbrake



477a

Illustration 29, Group B: a) Brakes, Footbrake

Key No.	Spare Part No.	Description	No. of Pieces	Remarks
Footbrake				
801	700 z 104	footbrake lever with shaft	1	
802	—	rubber sleeve B DIN 73 483	1	
803	670 z 232	brake lever	1	
804	—	hex. screw M 6 x 22 DIN 931 k (to fasten brake lever to footbrake lever shaft)	1	
805	—	spring washer A 6 DIN 127 k	1	
806	321 z 303	spring	1	
807	1551 z 222	hex. screw with tenon (for brake stop)	1	
808	—	hex. nut M 7 DIN 934 k	1	
809	6290 z 444	cable for footbrake, complete	1	
811	—	washer 10,5 DIN 125 k	1	
812	—	split pin 2 x 15 DIN 94 k (to fasten brake cable to front brake lever)	1	
813	121 z 1010	brake lever pin (to rear wheel brake cable)	1	
814	321 z 110	spring	1	
816	1023 z 01	toggle nut (to fasten brake rod to rear wheel brake lever)	1	
817	20 z 25	brakeshoe with lining	2	
818	49 z 13	brake lining	2	
819	1044 z 11	cylindrical rivet	18	
820	321 z 024	spring (between brakeshoes)	2	
821	1301 z 190	washer (to supporting tube)	1	

Illustration 29, Group B: a) Brakes, Footbrake

Key No.	Spare Part No.	Description	No. of Pieces	Remarks
822	—	circlip 14 x 1 DIN 471 (to fasten brakeshoes to supporting tube) .	1	
823	1100 z 24	brake cam	1	
824	671 z 174	brake lever	1	
825	1236 z 215	rubber ring (between brake lever and housing)	1	
826	—	hex. screw M 6 x 22 DIN 931 crp (to fasten brake lever to brake cam)	1	
827	—	spring washer A 6 DIN 127 k	1	

Illustration 30, Group B: b) Wheels

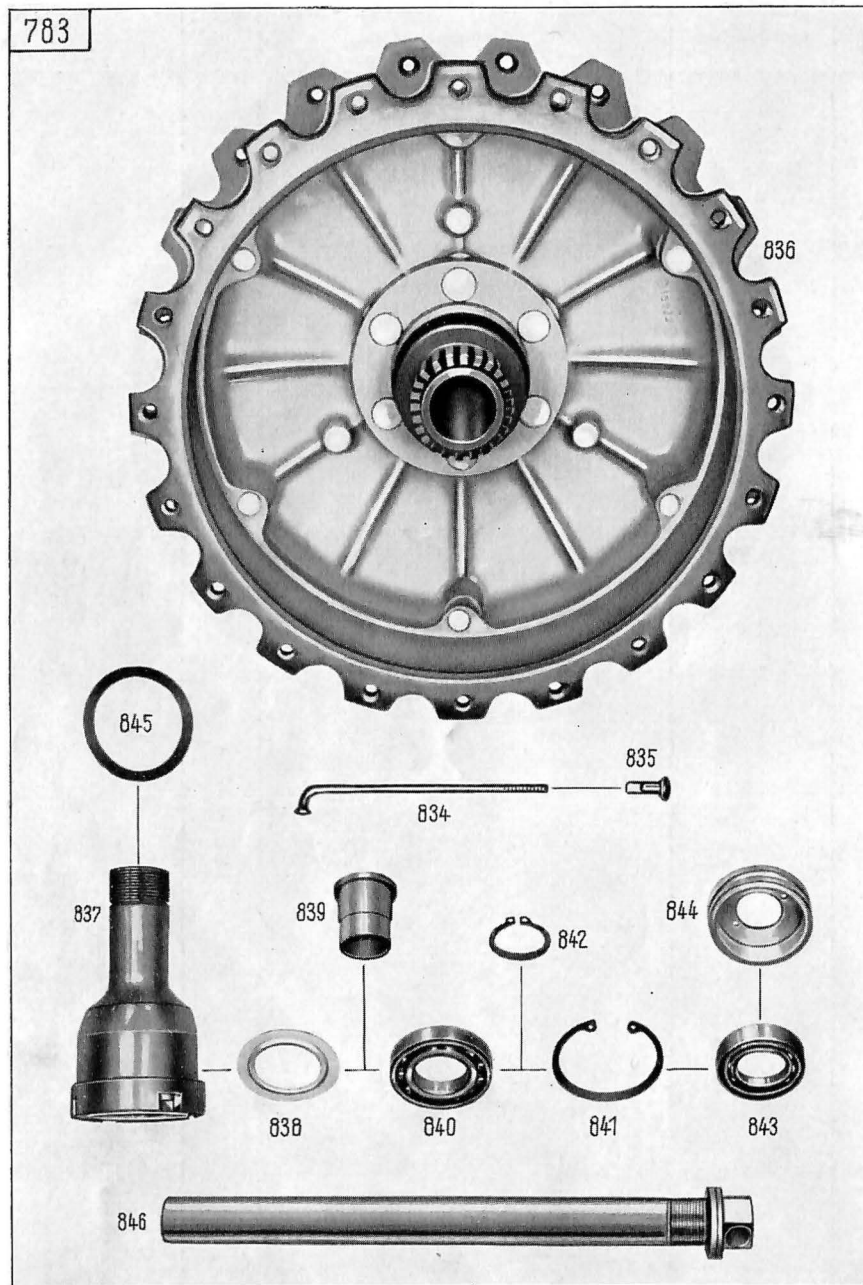

Illustration 30, Group B: b) Wheels

Key No.	Spare Part No.	Description	No. of Pieces	Remarks
Wheels				
—	6660 z 216	wheel without tire	2	
—	363 z 101	drop-center rim	2	
834	401 z 211	spoke, curved	80	
835	411 z 10	nipple	80	
836	1790 z 17	brake drum	2	
837	170 z 31	tightening bushing, complete (to fasten wheels to hub shell) . . .	2	left thread
838	1231 k 311	ring 30,3 x 37 x 47, sealing inside (to ball bearing 16005)	2	
839	184 z 323	bushing	2	
840	—	ball bearing 16 005 DIN 625	4	
841	—	circlip 47 x 1,75 DIN 472	2	
842	—	circlip 25 x 1,2 DIN 471	2	
843	—	radial packing ring A 25 x 40 x 10 DIN 6503	2	
844	1243 z 6	lock ring	2	
845	1236 z 209	rubber ring (between tightening bushing and wheel hub)	2	
846	131 z 529	rear wheel axle	1	

Illustration 31, Group E: a) Electrical Equipment, Generator

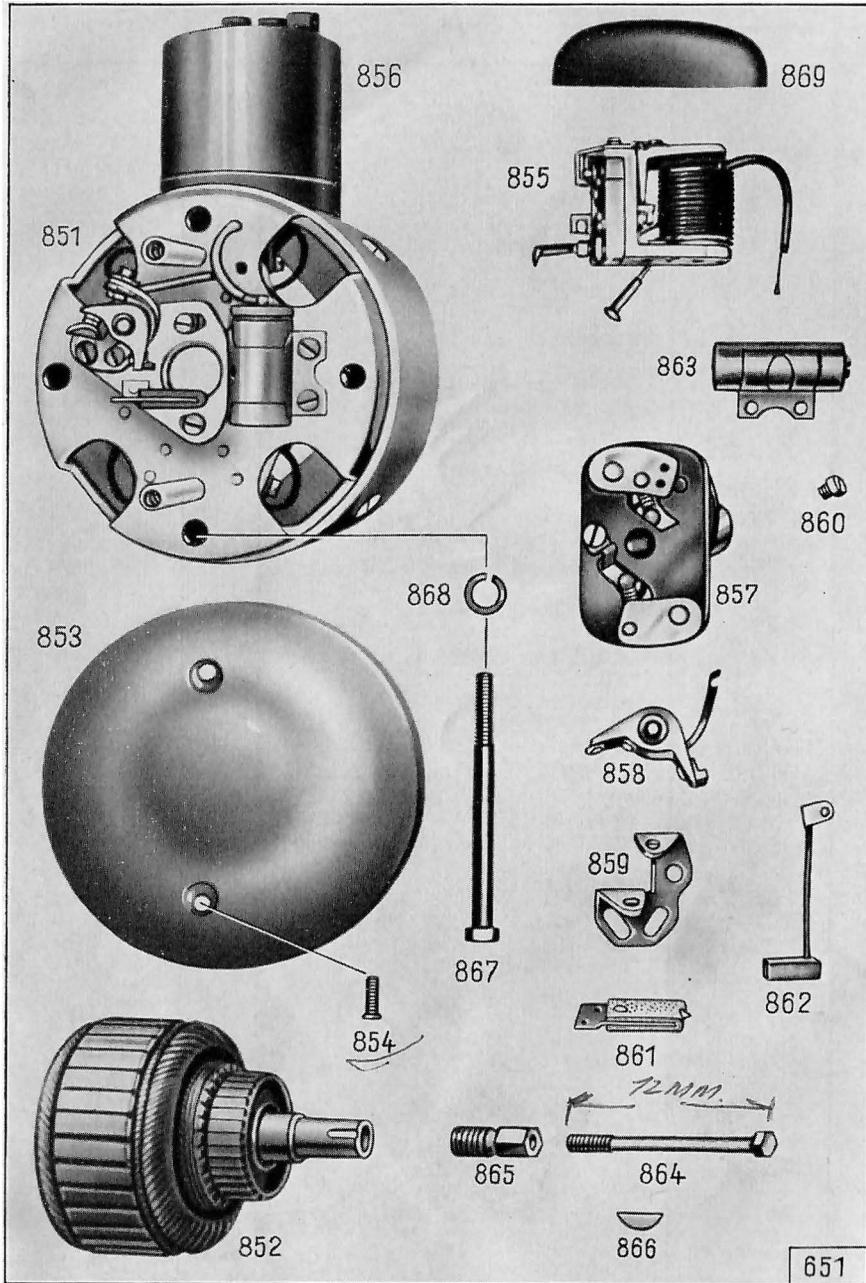
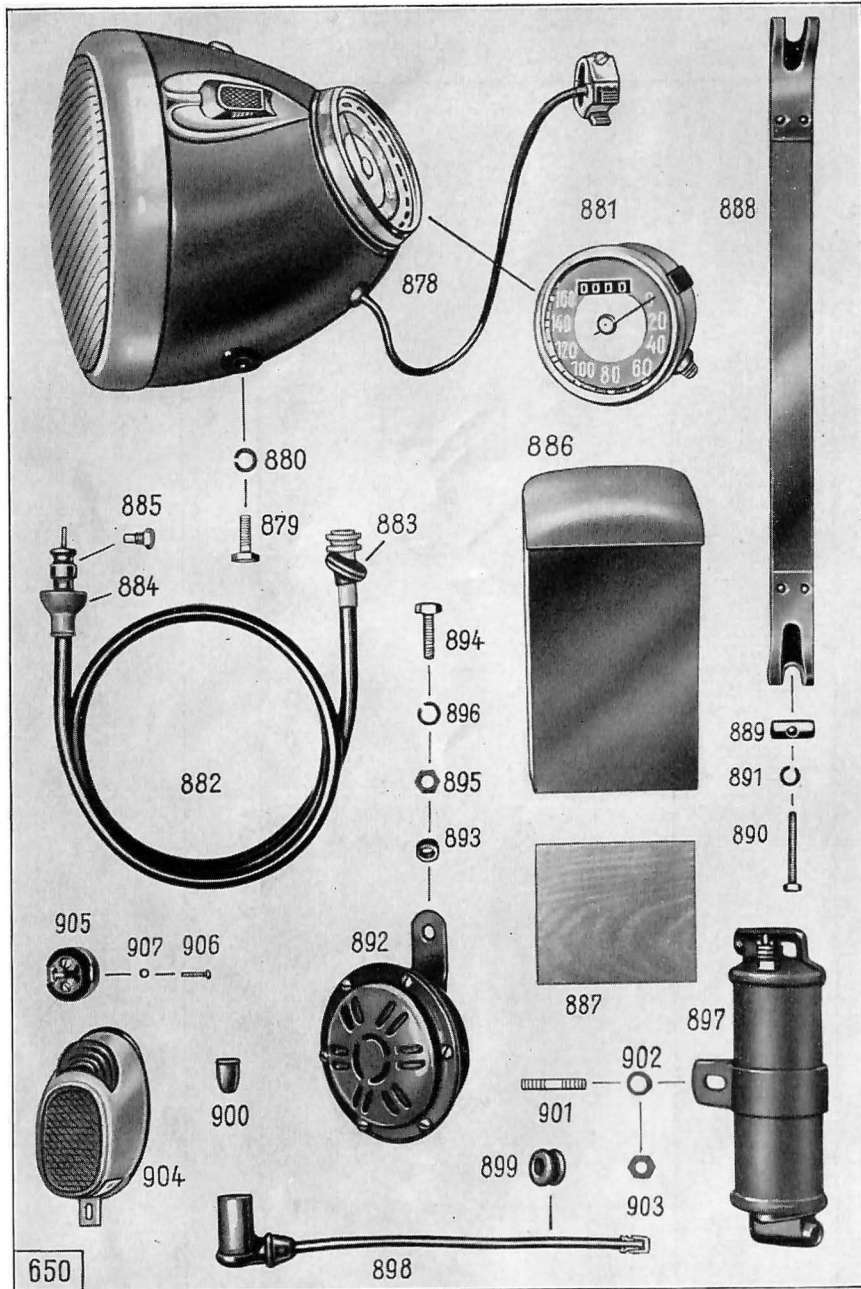

Illustration 31, Group E: a) Electrical Equipment, Generator

Key No.	Spare Part No.	Description	No. of Pieces	Remarks
Generator				
851	6070 z 74	generator, type NORIS D5a 6/90 L	1	
852	2290 k 33	armature	1	
853	2291 k 28	shell	1	
854	2291 k 18	fixing screw (to shell)	2	
855	2290 k 34	regulator	1	
856	2290 k 20	regulator cap Δ	1	
857	2290 k 32	automatic timing regulator	1	
858	2290 k 30	contact breaker arm with contact	1	
859	2290 k 35	contact bracket with contact	1	
860	2291 k 14	fixing screw (to contact bracket)	1	
861	2290 k 36	laminated spring with felt	1	
—	2291 k 15	copper rivet	2	
862	2290 k 11	carbon brush	2	
863	2290 k 7	condenser	1	
864	2291 k 27	hex. screw (to fasten armature and autom. timing regulator to crankshaft)	1	
865	1551 z 401	connecting screw (between armature and crankshaft)	1	
866	801 z 01	woodruff key 4 x 2,5 x 15 (within crankshaft)	1	
—	1238 z 01	packing washer	1	
867	2291 k 5	hex. screw (to fasten generator to crankcase cover)	4	
868	—	spring washer A 8 DIN 127	4	
869	616 z 35	rubber filler	1	

Illustration 32, Group E: a) Electrical Equipment, Headlight, Battery, Conducts



650

Illustration 32, Group E: a) Electrical Equipment, Headlight, Battery, Conducts

Key No.	Spare Part No.	Description	No. of Pieces	Remarks
Headlight				
—	6090 z 113-8	headlight, complete, with electric dip switch, ignition key, but without speedometer, bulbs, and cables	1	
—	2310 k 32	headlight shell	1	
—	2316 k 3	plug (for passage of speedometer drive cable which has not been used)	1	
—	2340 k 5	switch cover	1	
—	2311 k 37	distance screw, short	1	
—	2311 k 38	distance screw, long	1	
—	2310 k 14	reflector	1	
—	2311 k 30	rim with screw	1	
—	2317 k 3	headlight glass	1	
—	2316 k 4	packing ring (to headlight glass)	1	
—	2311 k 39	retaining spring (to headlight glass)	6	
—	2310 k 53	switch	1	
—	2310 k 55	clip (to switch)	1	
—	2310 k 33	ignition key	1	
—	—	rubber grommet A DIN 72 613 (for passage of cable)	2	
—	2310 k 18	holder (to Bilux bulb)	1	
—	2311 k 23	spring (to holder)	1	
—	6160 z 166	dip switch (on handlebar)	1	
—	2340 k 4	set of cables, 4 lines (from dip switch to headlight)	1	
—	2346 k 1	rubber grommet (to set of cables)	1	
—	—	Bilux bulb B 6 V 35/35 W DIN 72 601	1	Osram 7324

Illustration 32, Group E: a) Electrical Equipment, Headlight, Battery, Conducts

Key No.	Spare Part No.	Description	No. of Pieces	Remarks
—	—	parking bulb H 6 V 2 W DIN 72 601	1	Osram 3895
—	—	charge control bulb J 6 V 1,2 W DIN 72 601	1	Osram 3799
879	—	hex. screw M 8 x 25 DIN 931 crp (to fasten headlight to headlight carrier)	2	
880	—	spring washer A 8 DIN 127	2	
Speedometer				
881	6770 z 65	speedometer with lighting incorporated	1	
—	2426 k 1	rubber ring	1	
—	2421 k 4	knurled edge nut	2	
—	2421 k 3	bracket	1	
—	2424 k 2	bulb socket	1	
—	—	bulb J 6 V 1,2 W DIN 72 601	1	Osram 3799
882	6790 z 111	drive cable	1	
883	—	rubber grommet D DIN 72 613 (to drive cable at headlight)	1	
884	1806 z 36	grommet (to drive cable at rear end drive housing)	1	
885	1551 z 017	screw (to fasten drive cable to bearing bushing)	1	
Battery				
886	—	battery with inside terminals 6 V 16 Ah DIN 72 311	1	
887	1147 z 803	battery base	1	
888	1391 z 69	metal band (to clamp battery)	1	
889	1401 z 01	jockey pulley	2	
890	—	hex. screw M 6 x 40 DIN 933 k	2	
891	—	spring washer A 6 DIN 127 k	2	

Illustration 32, Group E: a) Electrical Equipment, Battery, Horn, Ignition Coil

Key No.	Spare Part No.	Description	No. of Pieces	Remarks
Horn				
892	—	horn 100 x 6 DIN 72 701	1	
893	1331 z 195	distance tube	1	
894	—	hex. screw M 8 x 25 DIN 931 k	1	
895	—	hex. nut M 8 DIN 934 k	1	
896	—	spring washer A 8 DIN 127 k	1	
Ignition Coil and Ignition Cables				
897	6190 z 21	ignition coil	1	
898	750 k 15	ignition cable, left-hand	1	
—	750 k 16	ignition cable, right-hand	1	
899	1806 z 06	rubber grommet (to crankcase)	2	
900	1806 z 08	rubber grommet (to spark plug cover)	4	
—	—	spark plug cover C DIN 72 566	2	
—	774 z 1	cable plug (at ignition coil)	2	
—	—	spark plug 14 DIN 72 502	2	Bosch 240 T 1 OR Beru 240/14
901	—	stud AM 8 x 15 DIN 835 k (to fasten ignition coil to crankcase)	1	
902	—	washer 8,4 DIN 125 k	1	
903	—	hex. nut M 8 DIN 934 k	1	

Illustration 32, Group E: a) Electrical Equipment, Battery, Taillight, Brakelight Switch,

Key No.	Spare Part No.	Description	No. of Pieces	Remarks
Taillight				
904	6110 z 46	tail — brake — number plate — light	1	
—	2320 k 6	cap	1	
—	1146 z 82	rubber plate	1	
—	2320 k 3	glass (to cap)	1	
—	2326 k 7	rubber grommet (for cable passage)	1	
—	—	bulb M 6 V 3 W DIN 72 601	1	
—	—	bulb K 6 V 1,5 W DIN 72 601	1	
—	—	screw, button head, AM 5 x 20 DIN 86 k	1	
—	—	screw, button head, AM 5 x 15 DIN 86 k	1	
—	—	washer, fan-shaped, J 5,3 DIN 6793 k	2	
—	—	hex. nut M 5 DIN 934 k	2	
Brakelight Switch				
—	6160 z 153	brakelight switch, without clamp	1	
—	1441 z 262	half of clamp (to frame)	2	
—	—	cylindrical screw M 5 x 15 DIN 84 k	1	
—	—	cylindrical screw AM 5 x 20 DIN 84 k	1	
—	1331 z 718	spacer tube (to frame clamp)	1	
—	—	hex. nut M 5 DIN 934 k	2	
—	—	spring washer A 5 DIN 127 k	2	
—	—	cylindrical screw AM 4 x 18 DIN 84 k (to fasten frame clamp to brakelight switch)	1	
—	—	spring washer A 4 DIN 127 k	1	
—	—	hex. nut M 4 DIN 934 k	1	
—	6160 z 169	plug (for connecting cables)	1	
—	—	protective cap H DIN 72 311 (to battery cable)	1	
—	1396 z 51	rubber band (to fasten cables to frame)	6	
—	1391 z 168	metal band (to fasten cables)	4	

Illustration 32, Group E: a) Electrical Equipment, Switch Plug Box, Conducts

Key No.	Spare Part No.	Description	No. of Pieces	Remarks
Switch Plug Box for Side-Car				
905	6080 z 37	switch plug box, complete	1	
906	—	screw, fillister head, M 3 x 15 DIN 85 k (to fasten switch plug box to tool box)	2	
907	—	spring washer A 3 DIN 137 k	2	
Electric Conducts				
—	760 k 242	set of cables, complete (to headlight)	1	} please order cables and sleeves resp. hoses by meters
—	—	rubber hose 10 x 12 mm		
—	—	L. T cable A 1,5 DIN 72 551		
—	1806 z 01	connection protector (to cable from headlight to ignition coil)	1	
—	—	cable shoe A 5 x 3 DIN 46 211	4	
—	144 z 21	cable shoe (to cable battery-ground)	1	
—	—	protective cap H DIN 72 311 (to cable battery-ground and battery-generator)	2	
—	1806 z 07	rubber grommet (to cancase cover)	1	
—	1396 z 51	cable band	5	

Illustration 33, Group W: a) Tool Box with Tools

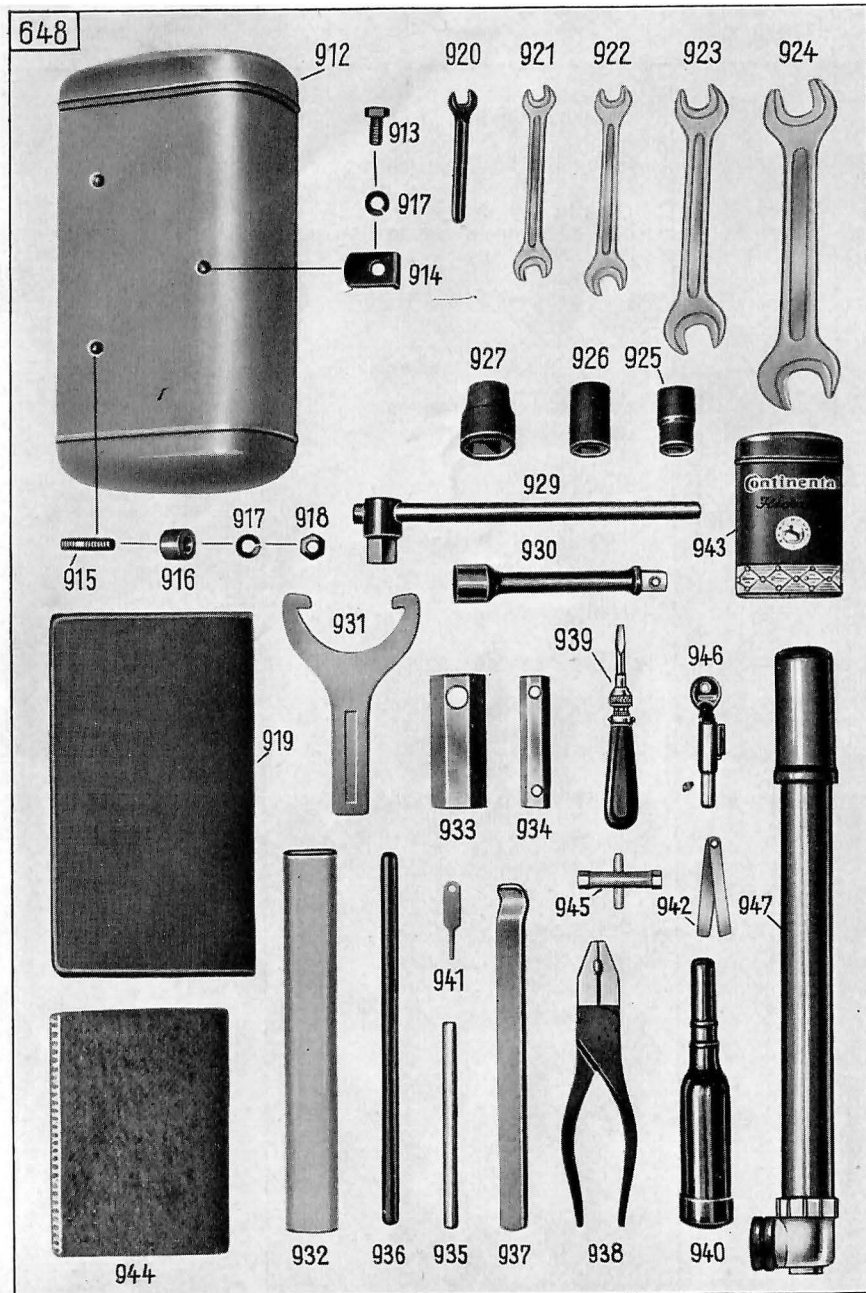

Illustration 33, Group W: a) Tool Box with Tools

Key No.	Spare Part No.	Description	No. of Pieces	Remarks
Tool Box with Tools				
912	6230 k 110	tool box	1	
—	6890 k 30	tool bag, filled	1	
913	—	hex. screw M 8 x 15 DIN 933 k	1	
914	2051 z 437	bracket	1	
915	—	stud AM 8 x 40 DIN 938 k	2	
916	173 z 102	distance sleeve	2	
917	—	spring washer A 8 DIN 127 k	3	
918	—	hex. nut M 8 DIN 934 k	2	
919	6040 z 161	tool bag	1	
920	—	one end spanner 7 DIN 894	1	
921	—	double end spanner 8 x 10 DIN 895	1	
922	—	double end spanner 9 x 11 DIN 895	1	
923	—	double end spanner 14 x 17 DIN 895	1	
924	—	double end spanner 19 x 22 DIN 895	1	
925	2021 k 44	socket wrench insert 14	1	
926	2021 k 45	socket wrench insert 17	1	
927	2021 k 46	socket wrench insert 24	1	
929	2021 k 48	handle with sliding piece (for socket wrench inserts)	1	
930	2021 k 49	lengthener (for sliding piece)	1	
931	2011 z 62	hooked wrench	1	
932	1331 z 624	lengthening tube (to hooked wrench)	1	
933	2021 z 21	socket wrench SW (opening) 21 mm	1	
934	2021 z 23	socket wrench SW (opening) 10/11 mm	1	

Illustration 33, Group W: a) Tool Box with Tools

Key No.	Spare Part No.	Description	No. of Pieces	Remarks
935	2001 z 15	turner (to socket wrench)	1	
936	2001 z 26	turner (to rear axle)	1	
937	2001 k 81	tire lever	2	
938	—	pliers 160 DIN 5244	1	
939	2009 z 102	srcew driver	1	
940	6040 z 06	grease gun	1	
941	2291 k 8	gauge for contact breaker	1	
942	2000 z 9	gauge for valve play	1	
943	6040 k 269	box with rubber repairing material (for tires and inner tubes)	1	obtainable on the market
944	2208 k 11	cleaning cloth	1	
945	2020 z 10	jet wrench (for carburettor)	1	
946	6040 k 252	pair of anti-theft locks	1	only included if ordered
947	6040 z 255	air pump	1	

